

See pages 14-17

(406) 433-3306 or 1-800-749-3306
Fax (406) 433-4114
e-mail address:
roundup@esidney.com

Business Office:
Located at 111 West Main
Sidney, MT

Mailing Address:
P.O. Box 1207
Sidney, MT 59270

Wednesday, October 5, 2011

Volume 37 • Number 33

Bakken NGL Pipeline Progressing

By Jodi McPherson

Oneok Partners representatives Steve Johnson, government regulations, and Brad Borrer, corporate communications, met last week with area press and Sidney Chamber of Commerce Executive Director Wade Van Every to discuss progress of the future Bakken NGL (Natural Gas Liquid) Pipeline.

"We are very encouraged by the progress being made," said Johnson. "Contacting and negotiating with landowners is moving forward and the regulatory agencies involved have been very accommodating."

Settlement with about 40% of the landowners in Montana has been made and plans to begin construction of the pipeline is set to begin May or June 2012, continuing until weather allows. "We want to do it right," said Borrer, "so construction in the winter is not an option." The pipeline is anticipated to be in service by 2013.

In July, Oneok Partners, a Tulsa, OK, based company, announced plans to build the multi-million dollar natural gas liquids pipeline through the region. The 500-mile Bakken Pipeline, starting near Sidney and traveling south through Wyoming into northern Colorado, will transport raw, unfractionated natural gas liquids from natural gas processing plants in the Bakken Shale area to the company's 50%-owned existing Overland Pass Pipeline which travels to Kansas where natural gas liquids are processed.

"This will be a safe and economical pipeline," said Johnson. "It will economically benefit the area with property tax dollars along with other businesses the construction will use." About 180 miles of the pipeline will run south through eastern Montana. Oneok will hire contractors to construct the pipeline in approximately four spreads.

"The rapidly increasing crude oil drilling activity in the region necessitates additional capacity to gather and process the growing natural gas volumes," said Terry K. Spencer, Oneok Partners chief operating officer, in a Oneok Partners press release in January.

Construction is now being done to complete three other natural gas processing facilities and gathering pipelines in Western North Dakota. Along with Oneok Rockies Midstream Plant, previously known as Bear Paw Energy Plant, they will quadruple the current processing capacity in the Williston Basin area. Oneok Partners will be investing \$1.5-1.8 billion in these growth projects.

The Bakken NGL pipeline is expected to deliver 60,000 barrels per day. Currently, Oneok has sold 80% of the gas that will be transported by the pipeline. The gas that is currently being burned off will be able to be contained and transported more efficiently.

The unfractionated NGLs produced from the Bakken Shale is transported by truck or rail at this time. With both NGL and crude pipelines, Bakken NGL and Keystone XL, being built, there will be less trucks hauling crude and NGLs to the market. A great benefit to the area.

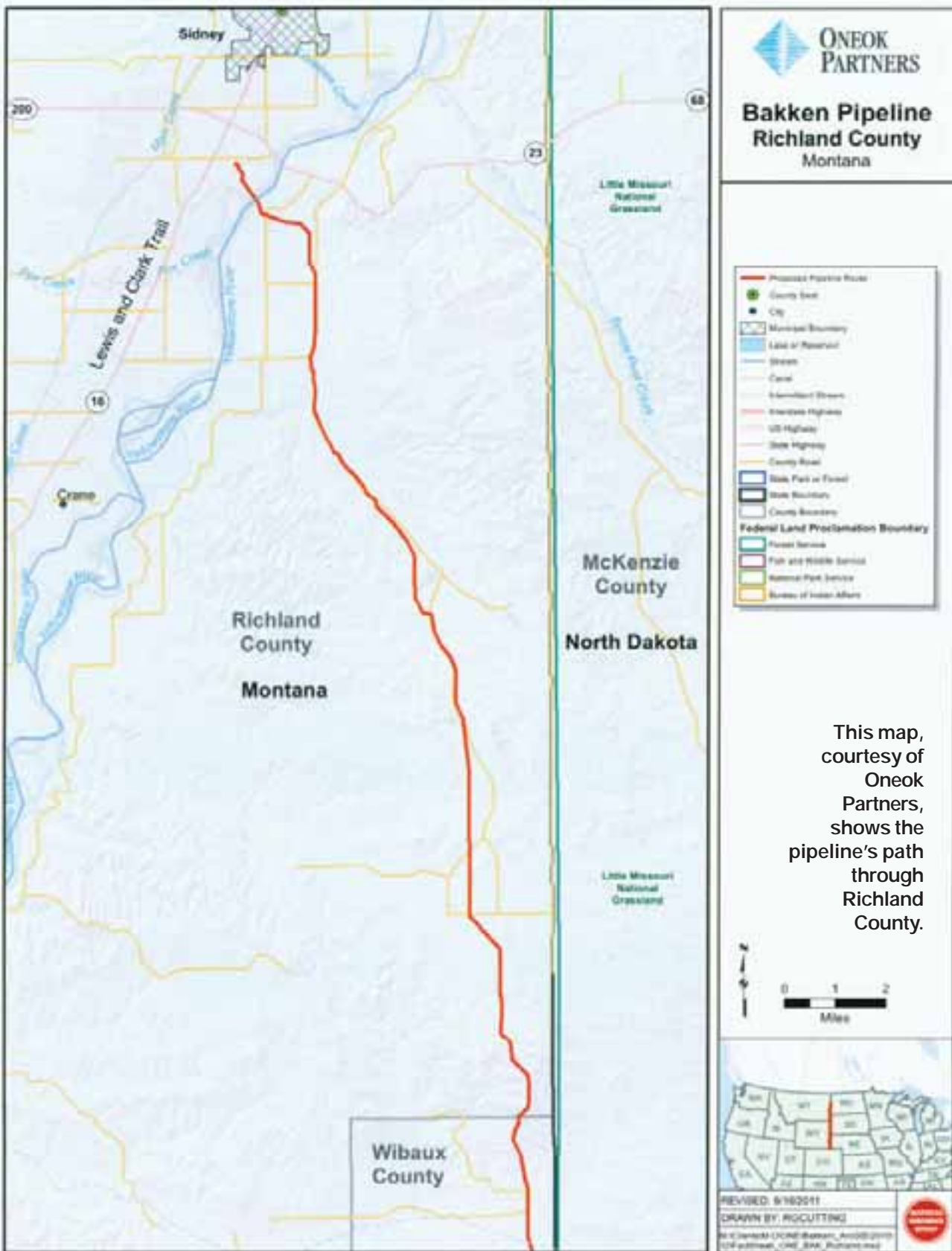

This map, courtesy of Oneok Partners, shows the pipeline's path through Richland County.



Savage Homecoming

Savage held its 2011 homecoming festivities last week. Britany Smith (left) was crowned homecoming queen and Chris Reynolds was named homecoming king during the coronation last Thursday night. See page 24 and www.roundupweb.com for more pictures.

Mike Gear Night Set For Friday

Sidney Eagle fans, alumni, friends and former players are invited to come celebrate a night in honor of Hall of Fame Football Coach Mike Gear.

Gear served for 35 years as head coach of the Sidney Eagles with 222 wins and 99 losses. He had 20 years in the playoffs, 10 divisional titles, 11 state championships and 9 state titles.

"Mike Gear Night" will be held at 6 p.m. on Friday Oct. 7, at Maurice Swanson Field in Sidney prior to the varsity football game vs. the Hardin Bulldogs.

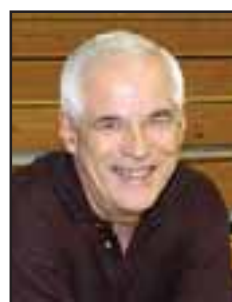

Mike Gear

Timmons Benefit Set For Nov. 20

There will be a benefit for Pastor Adrian Timmons on Sunday, Nov. 20, to help with medical expenses he has incurred as a result of a very severe car accident.

The benefit will be held at the Watford City Civic Center from 11 a.m.-4 p.m. Everyone is welcome.

DRWA To Hold Informational Meeting Oct. 27

There will be an informational meeting concerning the Richland County phase of the Dry Redwater Rural Water project at 7 p.m., Thursday, Oct. 27 at Girard Hall.

Brian Milne, Interstate Engineering, will provide information on the project and there will be plenty of time for questions.

Girard Homemakers will be serving homemade pie and coffee to attendees. Anyone interested in this important rural water project is encouraged to attend.

Open Early For Beet Harvest!
Hours: 5 a.m. - 4 p.m. Mon - Sat
5 a.m. - 2 p.m. Sundays

Great Home Cooking! *Sack Lunches Available!*

T&C Diner
 Marlene Emly Fairview, MT

Watford City Lions Club To Host Harlem Ambassadors Basketball Team Oct. 15

The Watford City Lions will be doing a fundraiser in sponsoring the Harlem Ambassadors Basketball Team again. It is similar to what the Chamber had done a couple of years ago. The game is scheduled at the Watford City High

School Gym on Saturday, Oct. 15 at 7 p.m.

Ticket prices are through age 4: no charge, Age 5-12: \$6 and Adult: \$7.

Funds will be used towards projects the Lions donate to: a low vision reader machine program in the area; Easter Egg hunt at the Good Shepherd Home; sponsor the Boy Scouts in Watford City and assist when needed; Leader Dog for the Blind; Leader Dog Assistance for the handicap dogs; sponsored and held the punt, pass and kick contest for football kids; North Dakota Lions Eye Bank; Run for Vision race; Relay for Life and serve the breakfast; plus numerous other community donations.

Binder-Hicks Announce Engagement & Forthcoming Wedding



Jade Binder and Mandi Hicks

Jade Binder and Mandi Hicks wish to announce their engagement and upcoming wedding.

Mandi is the daughter of Kitti Hicks and the late Jim Hicks, Lewistown.

Jade is the son of Mark and Diane Binder, Sidney.

Mandi graduated in 2007 from Lewistown High School and is employed with the Billings Health Department.

Jade is a graduate of Sidney High School and MSU Billings and is the owner/operator of Perfect 10 Roofing, Billings.

The couple will be married Nov. 11 at St Leo's Catholic Church, Lewistown.

Phun 4 Every 1! **PHEASANT PHEST 10.8.11**
6:00pm
Feed and Live Entertainment!

Hunters AND Non-Hunters! *Culbertson, MT* EVERYone welcome!

Join in the fun at **DRY PRAIRIE RURAL WATER** Culbertson, MT **\$25/PERSON**

Call 787-6401 to reserve Your ticket today!

*Tickets also available at:
 Hometown Market
 FCB-Culbertson
 Finnicums
 FCB-Froid
 Froid Grocery

Roosevelt Memorial Healthcare Foundation. rmtc.org

"Instant Wine Cellar and Fridge" • Adult Rifle • Jim Hansel Print
WIN! John Deere 625I Gator *And much more!*

For Sale
2008 GMC Yukon Denali

Excellent Condition
 48,500 Miles
 Loaded
\$36,000
 406-489-0251
 Located in Sidney

COATES ICE FISHING EXPO
 LARGEST ICE FISHING EXPO IN THE MONDAK REGION!

3 DAY INDOOR VENUE!

Friday through Sunday, October 21-23
Raymond Family Community Center
Williston, ND

Winter Sports
 Snowmobiles
 ATVs

Admission Is FREE

Factory Reps On Hand

Register To Win TRUE NORTH® FISH HOUSE

Ice Fishing
 • Ice Houses • Tackle
 • Electronics • Augers

FREE FOOD
 DONATIONS WILL BE WELCOME TO BENEFIT THE MINOT FLOOD RELIEF

Sponsored By: COATESRV.com

Williston, ND • 701.572.2250 • coatesrvnorthdakota.com

Northeastern Arts Network Concert To Be Held Oct. 6

The Northeastern Arts Network presents singer/songwriter Sara Hickman on Thursday, Oct. 6 as part of the Big Sky Concert Series. This concert will be held at the Sidney Middle School Auditorium at 7 p.m.

Whether a stirring rendition of her original songs, a children's show, or a workshop for songwriters, Sara's song craft consistently delivers heartfelt joy. From her live concerts to her appearances on "Austin City Limits" or "The Tonight Show", Sara is a dy-

namic and eclectic performer. Her fundraising efforts, as well as her dedication to heightening awareness of social issues such as homelessness and child welfare, underscore her humanitarian core. And, in recent years, Sara's natural talent for engaging and motivating audiences through song and speech has put her in demand as a keynote presenter. She writes and sings in commercials too.

Sara became the Official State Musician of Texas in

2010, following in the footsteps of the legendary Willie Nelson.

Sara Hickman's latest project has proven her dedication to raising awareness and funding for arts education programs in Texas schools. Her latest CD, "The Best of Times" was produced to benefit the Theatre Action Project, Austin, TX, a non-profit that brings art, music and theatre to Central Texas schools. Sales of this compilation of Sara's songs covered by 38 renowned Texas artists will go to benefit this project (TAP). Artists include: Willie Nelson, Marcia Ball, Shawn Colvin, Ruthie Foster, Jimmy La Fave, Edie Brickell and New Bohemians, Brave Combo, Robert Earl Keen... and dozens more!

Please bring a non-perishable food item to donate to the Sidney Food Bank in honor of Sara's humanitarian efforts and receive \$1 off any ticket purchased that

evening. Tickets prices at the door: adults \$15, senior \$13, and students \$10.

For additional concert information contact Candy Markwald 406-488-4155, Jill Hill 406-488-3845, or Karen Boehler 406-433-4375.

The Big Sky Series is made possible in part by the

Montana Performing Arts Consortium Presenter Development Program which is supported by grants from the National Endowment for the Arts, Montana Arts Council, legislative grant from Montana's Cultural Trust and WESTAF.



Photo of Sara Hickman from "Amazing Faith of Texas" (Photo Copyright © Randall Ford)

We are temporarily located at the

Hair Force

406-742-3302
Fairview

Racquel Schipman 489-0727
Jennifer Denowh 798-3541

Specializing in haircuts, colors & perms.

Now Open!

10 a.m. ~ 6:30 p.m. • Mon - Fri
10 a.m. ~ 5 p.m. • Sat

205 Main Street • Williston, ND
701-774-5050

Millers' Corner
Convenience Store, Deli & Catering

October Specials

Hershey's & Reese
Candy Bar Special
69¢

Chocolate Milk
25¢ Off

Clip & Save
Deli Coupon
Harvest Special
Cup of Soup,
Grilled Cheese,
Sm. Fountain Pop
\$5.25
with coupon

New Cake Pops
Proceeds donated by
Millers' Misfits to
Relay for Life

406-433-4041
2201 West Holly, Sidney

Roundup
WEB.COM

Big Selection **Free Financing 12 months All Furniture & Mattresses O.A.C.** **Low Sale Prices**

Home Design Center: Furniture • Mattresses • Flooring • Appliances • Paint • Housewares
Hardware Center: Hardware • Sporting Goods • Plumbing • Electrical • Tools • Lawn & Garden

JOHNSON

HARDWARE & FURNITURE
since 1915

Hours: Mon.-Fri. 8 a.m.-5:30 p.m. • Sat. 8 a.m.-5 p.m. • 406-433-1402 • 111 S. Central Ave., Sidney, MT • www.johnsonhardwareandfurniture.com

Attention!!

Mass FLU Shot Clinic

Wednesday, October 12th 2011
10 am to 6:30 pm

Richland County Health Department
Community Services Building on 1201 W Holly in Sidney
Bring your Medicare or Medicaid Cards with you.

Call RCHD for more information: 433-2207

Cut Me Out & Save

21 TVs
with NFL Sunday Ticket Just Got Better With a New Speaker System plus individual Sounddog Speakers for your table!

Winnery's PUB SPORTS BAR & Casino
Open 8am-2am Daily
804 S. Central Ave • 406-433-4636

Chance To Win
Super Bowl Party Tickets during every Sunday & Monday Night Game

Beer Pail Special Thursday
after the
Homecoming Bonfire

Wing Buffet
at the
Gear Alumni Party after Friday's Game!

New Flatlander Pizzas & Many Types of Wings On Our Menu
Available until close every night Call 433-4636 for Takeout

For all your Farm/Ranch, Recreational, Residential, and Commercial needs.



Alan Seigfreid
Amanda Seigfreid

Jim & Janice Knudsen 120 2nd St. N.E. • Sidney Mt. 59270
Broker/Owners (O) 406-433-3010 • (C) 406-489-3010
email: alans@midrivers.com
Website: www.missouririverrealty.com



Yellowstone Chiropractic Clinic
(406) 433-4757 222 2nd. Ave. SW
1-866-433-4757 Sidney, MT 59270



Dr. Ryan Laqua
Chiropractic Physician

• Sports Injuries • DOT Physicals
• Personal Injuries & Pain Conditions

Craft Bazaar
Saturday, October 8th



VFW Hall • 124 2nd Ave NE, Sidney
10 a.m. - 4 p.m.
Lunch will be served.

Gary & Travis Rindahl
Family Benefit

To Help Defray Medical & Travel Costs
Saturday, October 8 • Richland County Fair Event Center

Supper at 5 p.m.:
Roast Beef • Pulled Pork • Potatoes • Salads • Free Will Offering

Silent Auction: 5 - 7 p.m.

Live Auction Begins at 7:30 p.m.

Dance with DJ Jeff Nelson
following the auction

If you would like to donate an item for auction you may call the following people and they will pick up items:

Rhonda Pennington - 701-565-2259 • Diane Sult - 406-488-7857
Crystal Hatter - 701-565-2254 • Nancy Severson - 701-481-3249

Matching funds have been applied for through Thrivent Financial



are available in Williston at

- Hedderich's • Simonson's
- Scenic Sports & Liquor
- Herman Oil Convenience Store
- M & H Convenience Store

Pick up your FREE copy today!

SHS Publications To Host Homecoming Chili Feed Thurs.

The Sidney High School Publications will be hosting the Homecoming Chili Feed prior to coronation on Thursday, Oct. 6, from 5-6:30 p.m. in the Sidney High School Cafeteria. Cost is \$5 per person.

OBITUARIES

Dixie DeCourdes, 51, Fort Peck, MT

Funeral services for Dixie Louise (Thorgramson) DeCourdes, Fort Peck, MT are at 2 p.m. Wednesday, Oct. 5, 2011 at the Zion Lutheran Church, Fairview, MT, with Pastor Paul Brannan officiating.

Cremation will follow services under the direction of the Fulkerson Funeral Home, Sidney, MT. Remembrances and condolences may be shared with the family at www.fulkersons.com.

Dixie died Friday afternoon, Sept. 30, 2011 at Scobey, MT due to injuries in a vehicle accident.

Mary West, 67, Fairview, MT

Funeral services for Mary West, 67, Fairview, MT were at 2 p.m., Tuesday, Oct. 4, 2011 at the Zion Lutheran Church, Fairview, MT with Pastor Cal Oraw officiating.

Cremation will follow services under the direction of the Fulkerson Funeral Home, Sidney, MT.

Remembrances and condolences may be shared with the family at www.fulkersons.com

Mary died at the Sidney Health Center Extended Care Facility on Tuesday evening Sept. 27, 2011.

Verna Corine Shields, Butte, MT

Verna Corine Shields, Butte, MT, died Saturday, Oct. 1, 2011 of leukemia at home with her family at her side.

Verna's remains are in Wayrynen-Richards Funeral Home where friends may call.

Funeral services will be conducted in Journey Assembly of God Church with Pastor Randy Lindgren officiating. Interment will be in Mountain View Cemetery.

Harry Foss, 97, Charley Creek Community

Harry Foss, 97, a longtime rancher from the Charlie Creek Community died Sunday evening, Sept. 25, 2011 at the Roosevelt Medical Center, Culbertson, MT.

His funeral mass was celebrated on Friday, Sept. 30, 2011 at 10 a.m. (MDT) at St. Anthony's Catholic Church, Culbertson. Fr. Ray Nyquist officiated and interment was in the Hillside Cemetery, Culbertson. A Vigil service was held at St. Bernard's Catholic Church in the Charlie Creek Community on Thursday, Sept. 29, 2011 at 6 p.m. (MDT).

Friends are encouraged to share memories and condolences with the family online at www.fulkersons.com.

Fulkerson Funeral Home, Williston, assisted the family with the arrangements.

STATISTICS

Lake Water Level Reports

	Fort Peck	Sakakawea
Current Elevation.....	2237.9	1842.9
Last Week's Elev.	2238.3	1842.6
One Year Ago	2235.9	1847.9
Release For Day (C.F.S.)	9,300	25,800

Watford City Weather Data

Source: North Dakota Agricultural Weather Network

Date	High	Low	Precip.
Sept 2690	.50	0.00
Sept 2780	.45	0.00
Sept 2887	.47	0.00
Sept 2975	.42	0.00
Sept 3064	.38	0.00
Oct 177	.38	0.00
Oct 288	.49	0.00

Sidney Weather Data

Source: MSU Eastern Agricultural Research Center

Date	High	Low	Precip.
Sept 2685	.54	0.00
Sept 2787	.43	0.00
Sept 2885	.50	0.00
Sept 2972	.43	0.00
Sept 3080	.41	0.00
Oct 187	.49	0.00
Oct 287	.47	0.00
Average YTD Precipitation			12.29
2010 YTD Precipitation			18.21

McKenzie Electric Hosting Free Appreciation Dinner Wednesday

McKenzie Electric Cooperative will be hosting a free soup and sandwich dinner in honor of Co-op Month in October Wednesday, Oct. 5 at the Watford City Civic Center from 5-6:30 p.m.

Reservation Telephone and McKenzie Electric representatives will be available to answer questions and provide information.

Kiwanis Fruit Is Here!

Anyone who has ordered Kiwanis apples or pears is asked to pick up their fruit at the Johnson Hardware Warehouse, 3rd Ave. NE, just north of Action Auto, this Saturday, Oct. 8 from 9 a.m.-4 p.m. and Sunday, Oct. 9 from 11 a.m.-4 p.m.

EVENTS

SEND US YOUR EVENTS!

THE ROUNDUP: PO Box 1207, 111 West Main, Sidney, MT 59270
406-433-3306, Fax: 406-433-4114
Email: classads@esidney.com

Richland County

Events in Sidney unless otherwise listed. MT Zone.

- Wed., Oct. 5**
7 p.m. — Gambler's Anonymous, Millers' Corner back room.
- Thurs., Oct. 6**
12 p.m. — Sidney Kiwanis Club meeting, Elks Lodge.
5 p.m. — TOPS, Crestwood NW Entrance, Weigh-ins 5-5:30 p.m., meeting 5:30-6 p.m.
5-6:30 p.m. — Homecoming Chili Feed prior to coronation, SHS Cafeteria. \$5 per person.
7 p.m. — Bingo, early bird at 6:45 p.m., Moose Lodge
7 p.m. — Sara Hickman, Sidney Middle School Auditorium.
8 p.m. — NA meeting, Millers' Corner banquet room.
- Fri., Oct. 7**
7:45 a.m.-Noon — Richland Federal Credit Union Farmers Market, west parking lot.
- Sat., Oct. 8**
9 a.m. & 7 p.m. — AA meeting, Trinity Lutheran Church education bldg., 214 S. Lincoln.
10 a.m.-4 p.m. — Craft Bazaar, VFW Hall, 124 2nd Ave. NE. Lunch will be served.
5 p.m. — Rindahl Family Benefit, Richland Co. Fair Event Center.
- Sun., Oct. 9**
7 p.m. — AA meeting, Trinity Lutheran Church Education bldg., 214 S. Lincoln.
- Mon., Oct. 10**
11:30 a.m. — Doris Group meeting, T&C Diner, Fairview. Meet at 11:10 a.m., parking lot close to Moose Lodge to share rides. All Dorises welcome!
12 p.m. — AA meeting, Trinity Lutheran Church education bldg., 214 S. Lincoln.
6:45 p.m. — Bingo, St. Matthew's Parish Center multi purpose room.
- Tues., Oct. 11**
5:30 p.m. — Nurturing Program: Parenting Class, Sidney-Richland Co. Library basement, dinner included, daycare provided. To sign up call Nicole at 433-4097.
7 p.m. — AA meeting, Trinity Lutheran Church education bldg.

McKenzie County

Events in Watford City unless otherwise listed. CST Zone.

- Wed., Oct. 5**
8 p.m. — Pinocle Card Party, Eagles Club
8 p.m. — Al-Anon, Sanford Room, McKenzie Co. Public Library.
8 p.m. — 4-H Council Meeting, Courthouse Meeting Room.
- Thurs., Oct. 6**
8 p.m. — AA Group, Northern Pump & Compression. Call 770-3603 or 770-2675 for directions or a ride.
- Fri., Oct. 7**
8 p.m. — Al-Anon, Sanford Room, McKenzie Co. Public Library.
- Tues., Oct. 11**
6:30-8 p.m. — Nurtured Heart Approach, Courthouse Meeting Room.
- See all monthly events on our calendar at www.roundupweb.com.

PJ's Serves Meal To Workers

RoundupWEB.COM

Philip and Robyn Johnson of PJ's Auto Glass and Radiator Repair, Sidney, served up a meal of chili, grilled hot dogs and cookies to the folks camping at the Richland County Fairgrounds who are here to work the beet harvest. Robyn Johnson said they just felt it was the Christian thing to do, to help them out. "They are here in our community to help with harvest and we need to help them out too," Robyn said. They encourage other entities to show their community spirit and provide a meal as well. RVer Katie Spencer whose husband, Carl, is here to work the harvest, provided toiletries for the workers. She was grateful to Pamida for giving her a discount on the items. The workers will be here until the end of harvest.



Above: Philip Johnson serves a hot dog to Parker Stephens from Portland, OR.



Left: Robyn Johnson serves up chili with a smile to Joseph Moore.

esidney.com
is now
Roundup
WEB.COM
Everything
Roundup on
the web



COOKS ON MAIN
for the everyday chef

Fall Event
Saturday, October 8th

Demonstration & Tasting from
Vitamix 

10 - 4 p.m.

Cook like a Chef in no time
Pressure Cooking Class!
6 p.m. • \$40/Person • Limited Space

Open Monday - Saturday • 9:00 a.m.-6:00 p.m.
224 Main Street • Williston ND • 701-572-COOK (2665) • (F) 701-572-2666



It's Time to TAILGATE

STOCKMAN BANK TAILGATE BBQ
Friday, October 7 • 6:00 pm
South Parking Lot between
Football Field and High School

SPECIAL "STOCKMAN" MENU FOR HOMECOMING!
Marinated BBQ Pork Chops, Marinated BBQ Chicken Filets, or
BBQ Hamburgers, and BBQ Beans and Coleslaw for only \$5.00!
Proceeds donated to Sidney Community Education Foundation.

SIDNEY, MONTANA: 433-8600

Stockman Bank
MONTANA BANKING. PURE & SIMPLE™
WWW.STOCKMANBANK.COM



Lunch Specials!
*Test Drive One Of These
3 Great Vehicles & Have
Lunch On Us*!*

2010 Lincoln Navigator
13,828 miles, Silver

\$42,995

Stk# 5748



2005 F350 CC Lariat, Black

Now Only \$22,995

Stk# 5761
113,110 miles



2010 Ford Taurus SEL
20,417 miles

~~Was \$24,995~~
Now Only \$24,495

Stk# 5715





Eagle Country
Ford
Experience the Eagle Country Difference!

*Receive a voucher for a free lunch.

215 E. Main • Sidney, MT
406-433-1810
800-482-1810

National 4-H Week... October 2-8

FOR INFORMATION CALL:
 Richland County • (406) 433-1206
 McKenzie County • (701) 444-3451
 Roosevelt County • (406) 787-5312



CENEX Farmer's Union Oil Co.

 101 South Main
 Watford City, ND
 701-444-3639

i'm lovin' it
 Sidney, MT
 406-433-1983

"We Put Value On The Line"
Sheridan Electric
 Medicine Lake, MT
 406-789-2231

NEU CONSTRUCTION, INC.
 Oil Field Roads & Locations
 • Reclaim Work
 • Gravel & Scoria Hauling
 Fairview, MT
 406-742-5549
 neuconst@midrivers.com

Sidney Sugars
 INCORPORATED
Sidney Montana

MS MEATS
 703 E. Main • Sidney
 406-433-3410
 Mon-Fri 9-5:30
 Clay and Cheryl Moran

Prewitt & Company, LLC.
 Rod Prewitt • 480-2777
 Mike Yore • 480-2888
 Tim Larson • 480-2666
 Chantz Prewitt • 480-2222
 815 3rd NE
 406-482-5251

Agland Co-op
 See Us for All Your Fuel,
 Fertilizer, Oil, Chemical &
 Propane Needs.
 Froid, MT
 406-766-2339

MEDICINE LAKE AG SUPPLY MARATHON SEED CLEANING
Chris & Amy Ator Owners
 PO Box 245 • 220 Main Street
 Medicine Lake, MT 59247
 789-2524 • 789-2493
 Toll Free 1-866-528-7733
 Cell 765-7453
 marathon@nemontel.net

Nemont
 1-800-636-6680
 www.nemont.net

INDEPENDENCE BANK

 www.ibyourbank.com
 PO Box 188, Poplar, MT
 406-768-3916
 Branches in Poplar
 Havre • Glasgow • Malta • Scooby

Mon-Kota, Inc.
 Fertilizer & Irrigation
 Sales & Service
 Fairview, MT
 701-844-5300

Reinke
 MORE RIGHT THAN RAIN

STAGECOACH CASINO
 Hottest Spot on the Hi-Line
\$5 for \$10 in FREE Play in casino with coupon.
 Expires Oct. 31
 406-787-6181
 Culbertson, MT

TRI-COUNTY IMPLEMENT
 2429 W. Holly St.
 Sidney, MT
 406-488-4400 or
 1-800-624-6540

Wally's Grocery
 Poplar, MT
 406-768-3472

It's All About Saying Goodbye
Fulkerson Funeral Home
 315 Second St. NW
 Sidney, MT 59270
 406-488-2805
 email: ffh@fulkersons.com
 www.fulkersons.com

Enjoy

Coca-Cola CLASSIC
 Coca-Cola Bottling
 Williston, ND
 701-572-6746

Western Bank of Wolf Point
 111 3rd Ave. S
 Wolf Point
 653-5500

THESE AREA CLUBS WELCOME YOU!

Richland County

- Badlands Brushpoppers
- Brorson
- Lambert Hi-Liters
- Richland Rockets
- Three Buttes
- Yellowstone Valley Trailblazers
- Forever Buds
- Missouri River Ranchers
- Fair View
- Richland Aces

McKenzie County

- Banks Willing Workers
- Keene Lucky Leaf
- Ragged Butte Roughriders
- Sagebrush Ranglers
- McKenzie Individuals
- Double G
- Badlands 4-H Club
- Westside Rangers

Roosevelt County

- Centennial Clovers
- Missouri River Rats
- Frontier
- Tumbleweed
- Up-N-Atom
- White Tails
- Red Foxes
- Coulee Kids

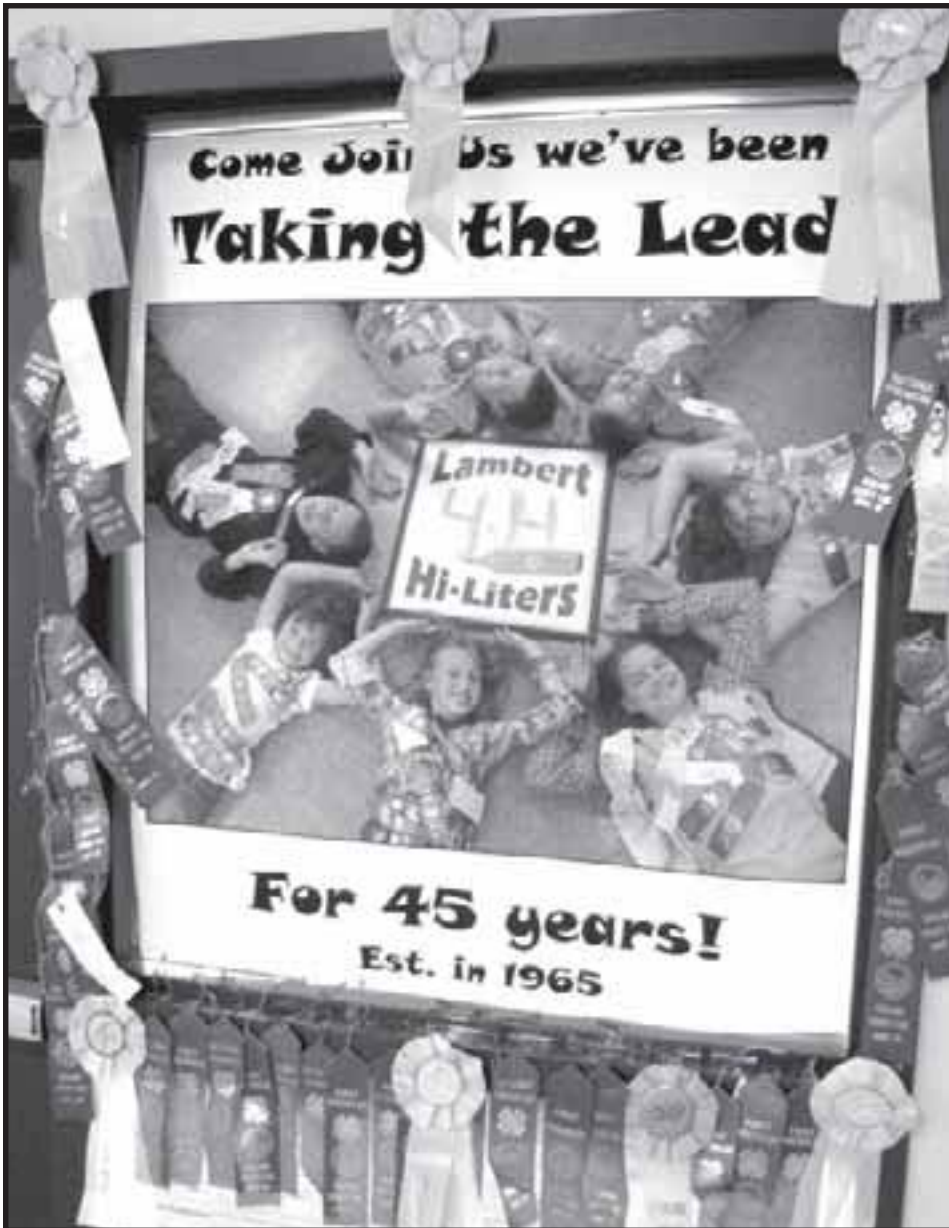

Dakota West
CREDIT UNION

329 N. Main • Watford City
701-444-6484
toll free 800-411-7590

Valley CROP CARE

904 East Main, Sidney, MT
406-482-1303
800-949-1303

Craig's MEAT PROCESSING 776-2447
Savage, Montana
NEW ADDITION
SLAUGHTERHOUSE

- custom meat processing
- curing & smoking
- sausage & jerky • wild game
- slaughter at the plant or your farm

Richland Farm Mutual Insurance

(406) 488-4898

Northland Feed & Seed, Inc.

Quality Feeds & Animal Health
Watford City, ND
842-3571

Frontier Heating • Refrigeration Air Conditioning

Sales/Service/Installation
Sidney, MT
406-488-4657

Pauper Industries, Inc.

PO Box 256
Lambert, MT
406-774-3330

Regal Eagle Casino & Lounge

900 1/2 South Central • Sidney, MT
Behind The Lone Tree Inn • 433-3245

McKenzie Electric COOPERATIVE

A "Techstone Energy" Cooperative
908 4th Ave. NE
Watford City, ND
701-444-9288

Northern States Fishing Tool Co., Inc.

Service & Rental Tools
Box 346
Watford City, ND
701-842-3350

Lower Yellowstone REA

Highway 16 NW
Sidney, MT
488-1602

pepsi

BLUE ROCK PRODUCTS CO.
501 9th Ave NE, Sidney
406-433-3403

THE DEPOT Casino KENO
POKER HAS PIZZAZZ

Hwy. 16 S • 406-433-4650
Sidney, MT
• WE DELIVER •

EVERSON - CLAYTON - STEVENSON CHAPEL

SYMPATHY • DIGNITY REVERENCE

Serving Northwest Montana call
Eversons @ 800-895-3738
or Clayton-Stevenson @ 406-653-2600

RTC

Smarter. Better. Faster.

www.RTC.coop
VOICE • DATA • VIDEO

Crop Production Services

Greg Breuer,
Accounts Manager

Office: 406-742-8800
Cell: 406-489-3429
Fax: 406-742-8801

First Security Bank West

FDIC

Box 465
Fairview, MT • 406-742-5203

Northwest FARM CREDIT SERVICES

Advancing Rural America's Success

123 N. Central Ave.
Sidney, MT 59270
(406) 433-3920
1-800-769-1040
www.farm-credit.com

Watford City Wolves Homecoming

Tues.-Fri., Oct. 4-7



• Full menu (steaks, seafood, hamburgers & pizza)
• Big Screen TV

701-842-2771
9 a.m.-10 p.m. Mon.-Sat.
4-6 p.m. Sun.
1/2 mile south on Hwy. 85



Alexander, ND
701-828-3352

For all your application & crop protection chemical needs!



Kent Taylor, Owner
Watford City, ND
701-444-3772
Licensed in ND & MT



Watford City, ND
701-842-3595



101 South Main
Watford City, ND
701-444-3639



Hwy. 85 W.
Watford City, ND
701-444-3122

Lund Oil Co.
Watford City, ND
701-842-2805



Service & Rental Tools
Box 346
Watford City, ND
701-842-3350



Front row (L-R): Lucas Nicholson, Charlie Hystad, Shawn Fulwider, Bailey Berquist. Back row (L-R): Brianna Allex, Clay Billing, Tillie Alveshere, Shawn Connolly.

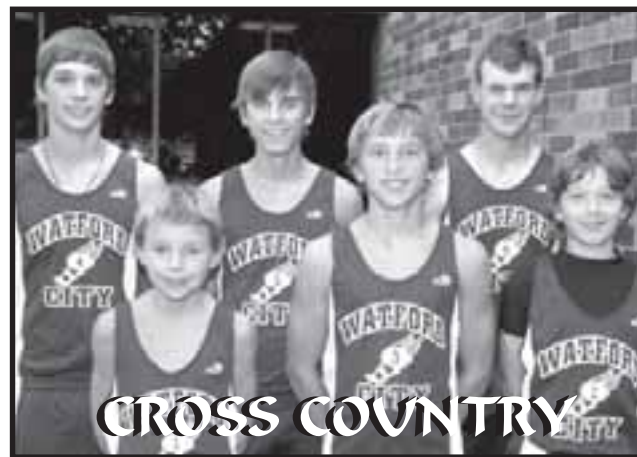

Back Row: John Meuchel, Dustin Kleppen, Hayes Feilmeier. Front Row: Hunter DeFoe, Logan Gumke, Devin Schmitz.



(L-R) Addison Sundeen, Bessie Schmitz, Kade Ross, Lea Arndt, Tara Loomer.

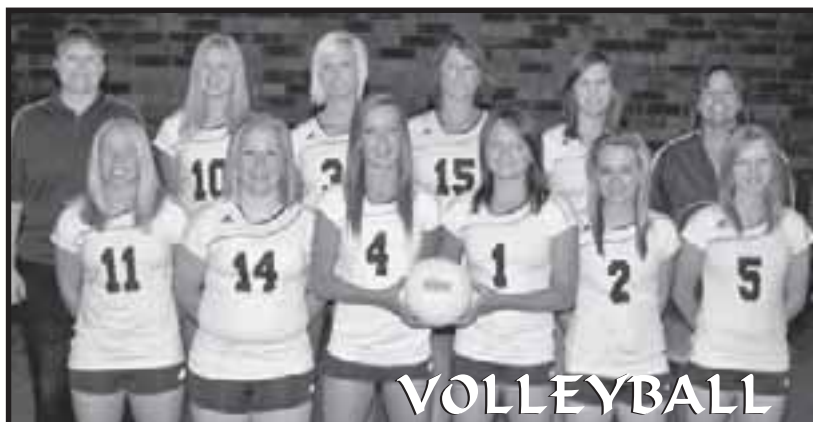

Back row (L-R) Head Coach Nancy Deutsch, Jessica Brown, Charlie Hystad, Taylor Sparby, Amanda Mogen, Assistant Coach Terrille Jacobson. Front Row (L-R) McKayla Haugeberg, Tillie Alveshere, Tori Hopkins, Brianna Allex, Jennifer Levang, Bessie Schmitz.



1st Row (L-R) Head Coach Fred Fridley, Nate Egeberg, Lucas Nicholson, Reid Brown, Andrew Sampsel, Shawn Fulwider, Steven Bascom, Corey Jones, Clay Billing, Gus Nelson, Cole Rolfsrud, Assistant Coach Justin Johnsrud. 2nd Row (L-R) Stat Ashton Pederson, Jaryn Homiston, Dillon Smith, Logan Fettig, Mitchell Liebel, Tyler Bates, Rich Stuchlik, Austin Garman, Justice Lafley, Brice Brenno, Jonathan Dunn, stat Madison Brown. 3rd Row (L-R) Assistant Coach Randy Cranston, Josh Rockeman, Jayden Grotte, Daniel Marmon, KeeganThompson, Brandon Stoker, Kalen Hartel, Josh Johnson, Kalden Heggen, Shawn Connolly, Chris Weckerly, stat MacKenna Leiseth, Assistant Coach Pat Fitzgerald. 4th Row (L-R) stat Sydney Slais, Cody Bellon, Michael Neprash, Wyatt Staal, Joseph Meuchel, Hunter Olson, Phillip Kellogg, Ryan Whitehead, Brandon Taylor, Shane Jorgenson, Charles Villanueva, stat Fallon Maston. 5th Row (L-R) Assistant Coach Eric Krogen, Erick Leiseth, Clay Jorgenson, Joe Nelson, Colter Maki, Brandon Allex, Cody Johnson, Rory Irwin, Cole Jore, Kelby Indergard, Dalton Wright, James Wahus. Not pictured: Davis Zubke, Beau Heiser and Justin Schwartenberger.

Agents with answers.

Eric Mogen
Watford City
444-6048



www.nodakmutual.com



Auto Body
Corky & Marla Hayden
405 7th St. NE
Watford City, ND
701-842-2797



329 N. Main • Watford City
701-444-6484
toll free 800-411-7590

S&S Motors

- Preowned Vehicles
- Full Service Shop

701-444-2341
WATFORD CITY, ND
www.sandsmotorsinc.com



MEMBER FDIC

Williston, ND 58801
701-774-8321
Watford City, ND 58854
701-842-2381



500 2nd Ave SW
701-444-6411
www.mckenziecountybank.com

MEMBER FDIC

Meyers Dept. Store
"Something For Everyone!"

200 N Main
Watford City
701-444-2906



Dennis Anderson
Representative
701-444-3273
229 N. Main
Watford City, ND

Delmar Rink Construction

Keene, ND
701-675-2458



Smarter. Better. Faster.

www.RTC.coop
VOICE • DATA • VIDEO



908 4th Ave. NE
Watford City, ND
701-444-9288



Friends of Angel Avenue

Left: Friends of Angel Avenue turned out to show support for the Second Annual Dementia/Alzheimer's Walk held Sunday, Oct. 2 in Fairview. There were 65 registered friends signed up, up from 45 last year, who walked the designated path. All donations collected will be given to Angel Avenue at Sidney Extended Care Facility to benefit residents. (Photo by Jodi McPherson)



Walking Proud

Emily Johnson, Fairview, proudly walked for the Second Annual Dementia/Alzheimer's Walk, in honor of her Grandmother Irene Knels. (Photo by Jodi McPherson)



Scentsy Representatives Donate 580 Flood Buddies

Scentsy representatives, (L to R): Keela Huotari, Jakki Waller and Carrie Edwards show some of the 580 Flood Buddies that were donated to children in Minot affected by the floods. Donations to purchase the flood buddies came in from Sidney, Williston, Fairview and Miles City as well as Minnesota, California, Arizona and Oregon. The ladies would like to thank the community for their amazing support of this project. The flood buddies were distributed in Minot last Saturday at the Town and Country Credit Union parking lot. Former Sidney resident Jennifer (Entzel) Lade, who now lives in Minot and lost her home to the flooding, made the necessary contacts to make sure the flood buddies were distributed to the children who need them. Go to Facebook/floodbuddy to see photos of the distribution.

Roundup
WEB.COM
Everything Roundup
on the web

Flu Shots Scheduled In Richey

The Dawson County Health Department will be at the Richey Senior Citizens Center, Richey, on Oct. 12 from 10 a.m.-1 p.m. to give flu and pneumonia shots. Fee for the flu shot will be \$30. Pneumonia shots will be \$75. Medicare will cover

the cost for Medicare recipients.

Please bring your card with you. Wear loose fitting shirts for ease of administering the shots.

Coffee and cookies will be offered for a free will donation.

The noon congregate meal will still be served. If you would like to eat at the Center, call by 10 a.m. on Oct. 12. Contact the Dawson County Health Department at 377-5213 or the Richey Senior Center at 773-5694 for further information.

Last Farmers Market of the year this Fri., Oct. 7

At the Richland Federal Credit Union West Parking Lot. Selling 7:45 a.m. to noon, or until gone.



A special thanks to our sellers and buyers for another successful year. Richland Federal Credit Union is proud to bring this service to the community.

www.richlandfcu.com



201 West Holly St. Sidney, MT 406-482-2704



Back To Fall!



PRIME RIB IS BACK!

STARTING SATURDAY NIGHTS 6 P.M.

HI-WAY LOUNGE & GRILL

701-828-3100 • Main Street • Alexander, ND

Attention Fairview Kids!

The Roundup, along with Fairview businesses is holding a sugar beet decorating contest in conjunction with Harvest Days. Decorated beets need to be dropped off at The Powder Keg between now and Tuesday, October 11. Prizes will be given to the top three in each of three age categories: five and under, 6 to 9 years and 10 to 12 years. Top prize in each age group is a \$20 gift certificate to the Powder Keg. Prizes will be awarded and pictures taken at 3:30 p.m. on Wednesday, October 12 at the Powder Keg.

Zero Down!

New home ready to move to your space or land!

\$482⁵¹*/mo.

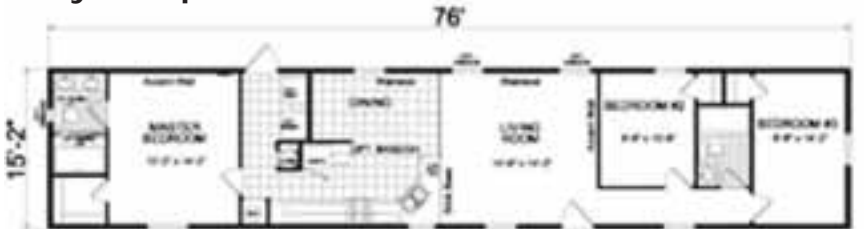

With approval of credit, this could be your home. 1153 Sq. Ft • 2x6 Exterior Walls • Good Insulation Values 3 Bedroom, 2 Bath • Spacious Kitchen w/Elec Range & Oven, Dishwasher • 17 Cu. Ft. Refrigerator, and more.

Only One Available!

Call Don 701-428-1949 for information & viewing



Crown Tree Homes

Sidney and Williston *10% Interest on a 20 year loan OCA

Watford City FFA Does Well At District Leadership

By Allison Monsen

The Watford City FFA Chapter along with nine other chapters from northwest North Dakota recently held its annual District Leadership Conference at Williston State College. Watford City was well represented with 27 of its members attending along with advisors, Justin Johnsrud and Scott Wisness. Watford City placed third in Chapter-of-the-day points, behind Stanley and Kenmare.

The Parliamentary Procedure team, consisting of our chapter officers received a silver award and placed third. Members were required to perform opening and closing ceremonies and demonstrate 10 abilities in parliamentary law. This is the most competitive event at the conference. Receiving a gold individual award were vice president Saige Feilmeier, treasurer Taylor Dwyer and sentinel McKayla Haugeberg. Receiving silver individual awards were reporter Allison Monsen and secretary Jennifer Levang. Receiving bronze was president Hayes Feilmeier. The team did very well demonstrating their knowledge of parliamentary law.

The chapter was well-represented in the public speaking events. Sam Jorgenson earned gold and was the runner-up in the Job Interview Event, which qualifies her for state. Cody Johnson earned bronze in

the creed speaking event. Tara Loomer received bronze in Extemporaneous Public Speaking. The demonstration team consisting of Joseph Meuchel and Andrew Sampson earned silver as well.

The Chapter Quiz team received a silver award. Taylor Dwyer and Tara Loomer received gold individually. Sam Jorgenson received bronze.

The Watford City FFA is also the sponsoring chapter of the Greenhand Parliamentary Skill Event. Twelve Greenhand

teams from seven chapters participated in this event. The Watford City team earned gold. These young members are required to demonstrate four skills in parliamentary law and debate as well as perform the official Chapter Ceremonies.

Fourteen Greenhands from the Watford City Chapter took part in this event. Receiving gold were Erick Leiseth as president and Hunter Olson as student advisor. Receiving silver were Kara Langerud, president; Charles Villanueva, vice president; Alivia Olson, treasurer; Coleton Jore, sentinel, Jayden Vaupel, student advisor; and Clay Jorgenson, president. Receiving bronze were Logan Fettig, secretary; Bailee Garman, vice president; Joseph Meuchel, secretary; Keegan Thompson, reporter; Wyatt Staal, treasurer; and Dalton Wright, reporter. Both teams received bronze.

Members attending the District Leadership Conference had a lot of fun. It was an excellent opportunity for them to develop their leadership skills.



Watford City FFA Attends District Leadership Conference

The Watford City High School FFA Chapter attended its annual District Leadership Conference at Williston State College. The chapter placed third in Chapter-of-the-day points. Shown are: front row (L to R) Coleton Jore, Alivia Olson, Kara Langerud, Bailee Garman, Tara Loomer and Clay Jorgenson. 2nd row (L to R): Hunter Olson, Erick Leiseth, Charles Villanueva, Joseph Meuchel, Jayden Vaupel, Brandon Taylor, Dalton Wright, Keegan Thompson, Wyatt Staal and Cody Johnson. 3rd row: Andrew Sampson, Hayes Feilmeier, Sam Jorgenson, McKayla Haugeberg, Allison Monsen, Saige Feilmeier, Jennifer Levang and Taylor Dwyer. Top: Nathan Egeberg, Clay Billing, Davis Zubke and Logan Fettig.



Tobacco Gardens Fishing

Pete Kummer (left) shows off his northern and bass while Duane Kummer (right) holds his northern and walleye. Below: Kari Kummer poses with her nice northern caught at Tobacco Gardens on Sept. 12.



Enter The Harvest Days Photo Contest

The Roundup is holding a photo contest to celebrate Harvest Days 2011. The theme is Women in Agriculture: The Unsung Heroes of the Farm.

Whether it's in the field or in the kitchen, women play an essential role in agriculture. Send in photos of your great grandmother homesteading or pictures from this year's harvest. We want to see them all!

Top prize is two 2012 Richland County Fair packages including fair buttons, tickets to the rodeo and concert.

Email entries to photos@esidney.com

Pictured is Kim Nollmeyer of Savage getting ready to irrigate.

Send your photos to PO Box 1207, Sidney, MT 59270 or drop them off at our office at 111 West Main. To be eligible the photos must be emailed or printed on photo quality paper, at least 4" x 6" in size at 300 dpi, fit the theme and include name, contact info and a description of the photo. Email photos and other required information to photos@esidney.com. Call The Roundup office at 406-433-3306 for more information. Images may be used in future Ag Roundup & Roundup publications. Entries must be received by Oct. 14, 2011.

Watford City Wolves Quarterback Club

Soup & Sandwich Feed

Friday, Oct. 7

WCHS Commons Area
4:30-6 p.m.

Come & enjoy some great food!

Turkey & Ham Sandwiches

Soups:

- Chicken Noodle
- Cheeseburger Chowder • Chili

Homecoming Game

7 p.m. vs.

Williams County

Adults: \$7 • Students (10 & Under): \$5

All proceeds go to the Quarterback Club & are used to buy new football equipment, uniforms, etc.

CHMS, P.C.
CERTIFIED PUBLIC ACCOUNTANTS
 Audits, Estate Planning, Business Consulting, Estate Tax, Income Tax
 P.O. Box 1067
 104 Second Avenue SW
 Sidney, MT
 406-433-2092
 FAX 406-433-2095

FARM & HOME SUPPLY
 809 EAST MAIN
 SIDNEY, MT
 406-433-3400

Shop Us for...
 • Furniture
 • Bedding
 • Appliances
FINNICUM'S
 1051 S Central • Sidney, MT
 406-433-5373

SIDNEY LIQUOR STORE
 Open:
 Mon.-Fri. 9 a.m. - 6 p.m.
 Sat. 9 a.m. - 5 p.m.
 The only local retail liquor store.
 809 E Main St, Sidney, MT
 406-433-2862

Valley CROP CARE
 904 East Main, Sidney, MT
 406-482-1303
 800-949-1303

We're Proud to Support the Sidney Eagles!

BLUE ROCK PRODUCTS CO.
 501 9th Ave NE • Sidney, MT
 406-433-3403

ScreenPlay
 Erin and Ty Graves
 2405 West Holly St. • 433-2400
 screenplay@midrivers.com



SIDNEY EAGLES

Homecoming Week

Tues.-Fri., Oct. 4-7

Homecoming Events

Tuesday - Toga Day-wear regular clothes under the toga
Wednesday - Western Day
Thursday - Treasure Day; Chili Feed 5-6:30 p.m., high school cafeteria, \$5 per person; coronation 7 p.m., gym; bonfire following coronation
Friday - Fighting Eagles - Maroon & White Day. Parade begins at 2:30 p.m.; Froshmore football game vs Hardin, 4 p.m.; varsity football game at 7 p.m. vs. Hardin
Saturday - 11 a.m. Cross Country in Miles City

Homecoming Candidates



Back (L-R) Shay Steinbeisser, Josh Torgerson, Zach Hoffman, Alex Irigoien, Ryan Sullivan. Front (L-R) Alexis Dynneson, Cedar Lewis, Karley Leland, Lizzy Gangstad, Madeline Warner.



Cross Country

Back (L-R) Brant Pewonka, Tori Hill, Stephanie Gomez, Lyndsay Nesper, Olivia Hintz, Sam Gangstad, coach Katie Haase. Middle (L-R) Madison Jurgens, Lizzy Gangstad, Katie Staffanson, Draven Partridge, Lakayla Nentwig, Lexi Hernandez. Front (L-R) Dain Earwood, Mikayla Verhasselt, Molly Wilkinson, Jared Trout.

Gem City MOTORS
 GMC AN AMERICAN REVOLUTION
 BUICK The New Class of World Class
 703 S. Central • Sidney
 406-433-3120
 www.gemcitymotors.com

It's All About Saying Goodbye
Fulkerson Funeral Home
 315 Second St. NW
 Sidney, MT 59270
 406-488-2805
 email: ffh@fulkersons.com
 www.fulkersons.com



SCHOOL

SPIRIT

SUPPLIES

POPCORN

IN YOUR

COLORS!

PARTY CENTRAL
 & Main Street
 105 E. Main St. • Sidney, MT
 (406) 433-4386

Mitchell's Oilfield Service Inc.
 Oilfield Construction
 Maintenance • Trucking • Cranes
 Located 2 miles south of Sidney on Hwy 16
 Sidney, MT • 406-433-4927
 Baker, MT • 406-778-3221
 Glendive, MT • 406-345-3221
 Watford City • 701-842-4927
 Bowman, ND • 701-523-3040
 Killdeer, ND • 701-764-5528

John Stockhill JEWELERS
 The House of Jewels
 116 S Central Ave
 Sidney, MT
 406-433-2702

Sidney Body Shop

 1301 S. Central • Sidney, MT
 406-433-2948

Don't Forget...
 • Softshell Saturday
 • Taco Tuesday
 • Taco Bravo Thurs

 724 S Central Ave
 Sidney, MT
 406-433-2295



Volleyball

Back (L-R) Daryn Wolff, Mikayla Minow, Abby Haraldson, Whitney Leuenberger, Madeline Warner, Tori Getchell, Rietta Iversen, Jalyssa Gorder, Elise Torgerson. Middle (L-R) Krista Steinbeisser, Cedar Lewis, Chelsea Strasheim, Sheridan Sundheim, Lexi Prevost, Ashley Bjork, Morgan Thiel. Front (L-R) Toree Todd, Kelsey Halvorson, Erin Harris.



Golf

Back (L-R) Jay Frank, Dustin Bailey, Colin Moran, Brett Montgomery, Kevin Fike, Luke Montgomery, Marcus Mayer. Middle (L-R) Connor Frank, Paul Brannan, Bryan Messer, Thomas Shaffer, Bobby Frank. Front (L-R) Keevin Edam, Abby Ries, Jocelyn Murphy, Nicole Moore, Koby Edam.

Melby Construction
Gutters • Fascia • Soffit
• Siding • Shingles
A family business protecting and improving your family home.

Creative Curbing
Guy Melby Phone:
1-406-488-6624

Sidney Sugars
INCORPORATED
Sidney Montana

PIZZA HOUSE

Call Us For Delivery
433-1971
Sidney, MT

TRI-COUNTY IMPLEMENT

2429 W. Holly St.
Sidney, MT
406-488-4400 or
1-800-624-6540

CASE III

DARK INDUSTRIES INC

Water Trucks • Frac Tank Heaters
• Winch Trucks • Vac Trucks
Frac Tank Rental • Hot Oil Trucks

Office
406-433-4346

Tim Partin 406-489-4988 Killdeer
Jeff Partin 701-764-6434

GURNEY ELECTRIC Inc.

Sidney, MT • 406-482-3204
*Electrical Supplies & Equipment
*Decorative Lighting
*Electrical Service

Olson Plumbing & Heating

PO Box 375 • Sidney, MT
482-4027

•Quality
•Everyday Low Prices
•Courteous Full Service

Chad's Furniture
SIDNEY, MONTANA

302 East Main
Sidney, MT
406-433-1005

Richland Pump & Supply

(406) 488-8706
David Williams
Cell (406) 489-8706
Scott Ramus
Cell (406) 489-8707
1511 S Central Ave • Sidney

MJA SALON

120 2nd Ave SE
Sidney, MT
406-433-4583

"Dig 'er Done!"
GORDER TRENCHING

• Trenching for new and existing Home Waterlines
• Your local Montana Fiberglass Stock Tank Dealers

Specializing in Farm & Ranch Waterline and Water Tank installation

Shane & Lisa Gorder
428-9672
11685 CR350 • Sidney

THE DEPOT
POKER **Casino** KENO
HAS PIZZAZZ

Hwy. 16 S • 406-433-4650
Sidney, MT

• WE DELIVER •

Football



Back (L-R) Jory Stevens, Cody Schroeder, Christian Gomez, Kyle Keller, Brandon Moore, Dustin Renders, Cody Christian, Nate Knudson, Caleb Benson, Carl Redman, Jim Topp, Lane Lyseng, Cody Sissel, Dace Fisher, Mark Lapan, John Haraldson, Joshua Alexander, Kory Halvorson, Nathan Anderson, Allen Neuleib, Braydn Rooks, Daulton King, Austin Bridges, Tyler Quilling. Middle (L-R) Cody Johnson, Jake Lunderby, Taylor Searer, Austin Lange, Douglas Rooney, Zach Hoffman, Louie Reyna, Austin Kendall, Justin Brown, Jeremy Rhines, Morgan Kohntopp, Cody Steinbeisser, Brandon Miller, Logan Thiel, Chisum Lewis. Front (L-R) Ryan Buckles, Iggy Garcia, Ryan Sullivan, Alex Irigoien, Brody Rooks, Gresh Jones, Josh Torgerson, Ethan Graves, Rylee Peterson, Spencer Brost, Joe Barsotti, Trevor Tracy, Jordan Stevens, Jesse Ziler, Cile Geiser.

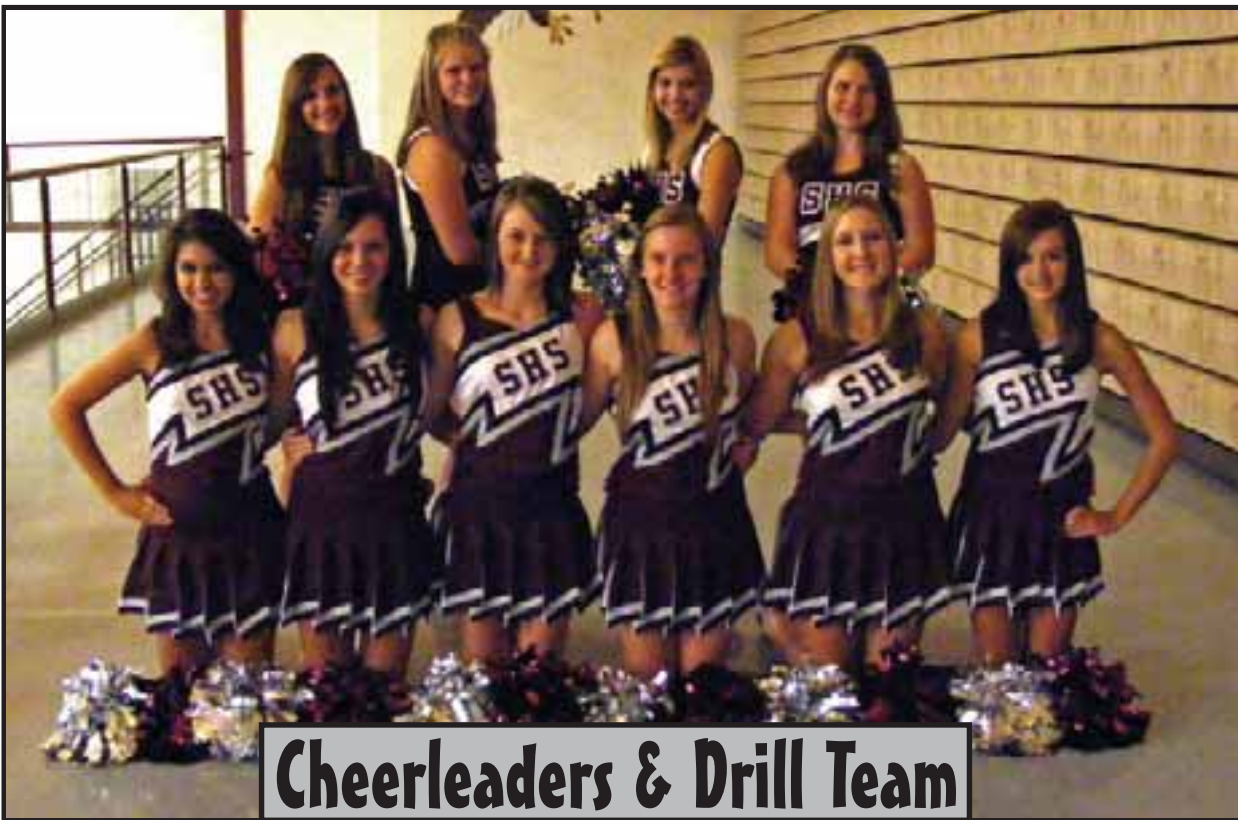

Cheerleaders & Drill Team

Back (L-R) Bree Herbst, Heidi Anderson, Kacie Ramus, Taylor Thiessen. Front (L-R) Julie Theis, Jalyssa Gorder, Briana Wilcoxon, Chelsea Strasheim, Heather McDonald, Megan Johnson.



Mascot

East-Mont Enterprises Inc.

- Candy
- Paper Goods
- Cleaning Supplies & More!

608 E. Main • Sidney
Wholesale Distributors
406-433-2910

ARMSTRONG LAW OFFICE
P.C.

Lee E. Armstrong
armslaw@midrivers.com
Licensed in Montana and North Dakota

406-433-7700
FAX 433-7720
212 S. Central

Eagle Country
Ford

Experience the Eagle Country Difference!

Mon-Fri. Hours: 8 - 5 p.m.
Sat. Hours: 9 - 1 p.m.

215 East. Main St. • Sidney
1(800)482-1810 • 433-1810

i'm lovin' it

Sidney, MT
406-433-1983

Hedahl's Auto Plus

115 2nd Ave SE
Sidney, MT
406-482-3304
1-800-962-7068

FOR YOUR TIRE NEEDS GO TO

PRO TIRE

We now have
Wrecker Service

OWNED & OPERATED BY
STEVEN GEISER

Mon. - Fri., 7 a.m. - 5:30 p.m.
Sat., 8 a.m. - 4 p.m.
406-433-8473

M&M Cafe

Restaurant
Catering
Specialty Events

Open
Mon.-Sat. 5 a.m.-9 p.m.
Sunday 5 a.m.-8 p.m.

1721 S. Central Ave. • Sidney
406-433-1714

SEITZ

INSURANCE AGENCY

114 2nd Ave SE
Sidney, MT
406-433-1411

Good Luck Eagles!

MS MEATS

703 E. Main • Sidney
406-433-3410
Mon-Fri 9-5:30

Clay and Cheryl Moran

C & L Chariot
Charlie & Loretta
Dowse

Call to book
your trips!

Sidney, MT
406-488-4015
406-489-3464

Regal Eagle

Casino & Lounge
Behind The Lone Tree Inn In Sidney

Happy Hours 4-6 Weekday
50¢ Off All Drinks

THINK OF
THE
POSSIBILITIES!

B&B BUILDERS

Sidney, MT • 482-4401

SIDNEY TAX SERVICE, INC.

Computer Accounting
Tax Returns • Payroll

DOUG LANG
BILL ZIMMERMAN
CRAIG PRICE

115 2ND ST NE • SIDNEY, MT
406-433-3131

Frontier

Heating • Refrigeration
Air Conditioning

Sales/Service/Installation

Sidney, MT
406-488-4657

B & J Refrigeration & Heating

Rheem

(406) 482-4744
607 2nd St. SE
Sidney, MT

24 Hour Service

IGA

Reese & Ray's IGA

203 2nd St. NW • Sidney
406-482-3737

TRIANGLE NITE CLUB

Restaurant Hours:
Monday - Friday 5 - 10 pm

Bar Hours:
Monday - Friday
3 pm - 10 pm +

Restaurant • 406-433-4709
Bar • 406-433-9936
Sidney, MT

ACTION AUTO

Jeep
CHRYSLER
Dodge Dodge Trucks

406-433-2312
1-800-788-2312
220 E Main
Sidney, MT

**Special
Section**

HUNTING EDITION

Dog Training Means Repetition, Consistency, Time

By Lois Kerr

Upland bird season has arrived, and hunters tend to separate into two loose groups: those who hunt with dogs and those who hunt without the assistance of a four-legged friend. Those who prefer to have trained dogs along to help with the hunt generally use either pointing or retrieving dogs in their quest for game birds.

Bob Crandall, Yellowstone Kennels owner/operator, Sidney, trains both pointing and retrieving dogs but he specializes in the retrievers, as he believes retrieving dogs best fit the bill when hunting the most popular upland game bird – pheasant.

"The vast majority of upland hunting is for pheasant," Crandall remarks. "It is the most popular game bird and the most heavily hunted. Pheasants don't sit tight like Bobwhite quail. They seem to have roadrunner genes and prefer to hightail it out and keep going, and they generally go to the nastiest terrain they can find."

He continues, "Labs are the most popular and most used bird dogs in the country today. Retrievers will go into nasty terrain and flush birds, the hunter then shoots the bird, and the dog retrieves it. Because of this, Labs and pheasants are a natural match, so I spend my efforts on the largest area of interest; that of pheasant hunting with a retrieving dog."

Crandall summarizes good dog training into five words: repetition and consistency over time. Without consistent repetition of a task over a period of time, dogs will not perform as people expect them to. "The biggest mistake people make is that they try to go too fast," Crandall says. "A pup born in April cannot be a finished dog by October. Dogs have to have time to mature, and education has to come over time, just like with a child."

He continues, "You have to understand that you can never expect anything from a dog if you haven't given it enough repetition, and a dog is only as good as you expect it to be. To accomplish training, you must repeat and repeat the lessons, and you must have high standards to adhere to, which means consistency."

The repetitions and consistency in standards begin at weaning and continue on through the dog's early years, with additional learning added after the dog masters the basics. "Dog training is choosing the right tasks to repeat and repeat until it becomes a conditioned response," Crandall comments.

"Obedience is a conditioned response obtained through a tremendous number of repetitions."

Crandall believes all dogs need a basic foundation before they can learn additional tasks and become a finished dog. "I call the basic foundation 'yard work' where the dog learns basic commands so when you go to the field, you have some control," he says. "Basic yard work teaches a dog to come when called, sit when ordered, to heel on both sides, and the 'NO' command. I don't teach 'stay'. Rather, I teach an extended sit, which means the dog is taught to sit until it is told to do something else. The extended sit preps the dog to anticipate another command. This anticipation for the next command is what allows the trainer to teach dogs to respond to whistles and hand signals."

Ideally, a pup begins its education and training at weaning, learning its name, the word 'no', coming when called, and to learn and feel comfortable in its environment. "Dogs need a good environment to learn social skills," Crandall says. "Teach them the basics like their name and take them on walks around other people, expose them to noise, distractions, and change. Serious yard work then builds on what the dog already knows."

It takes a few years to produce a finished dog. Crandall teaches the basics the first year of a dog's life, including exposure to gunfire. He takes the dogs to the field and allows them to chase birds, have fun, and stoke their enthusiasm and interest in birds. The second year he refines the basics the dogs already have learned, refinements that turn them into finished, well trained retrieving dogs. "I build on the basics," Crandall remarks. "Dogs learn skills such as how to mark falls, run blinds, and run through obstacles and water."

Crandall trained dogs for years as a hobby before he turned to training dogs professionally. He credits both humans and dogs with teaching him the ropes. "I was introduced to dog training in 1970 when I worked for a kennel while attending college," Crandall remarks. "I knew five professional trainers who taught me a lot, and I've met a lot of very good dogs that taught me even more. The best teachers are the dogs, because each dog is unique and each dog teaches you something."

He adds, "I trained dogs for years as a hobby, but when it came time for me to retire, I turned an avocation into a vocation and began training dogs professionally. I enjoy this



Tess, a young dog in training, awaits the command to retrieve.

very much. I take fewer dogs each year due to my age, but I really enjoy what I do."

As a young man, Crandall learned from other pros. He has returned this favor in his later years by helping in the training of an up-and-coming young area man, Tim Averett, who shows extraordinary promise as a trainer of retrieving dogs. "Tim is the best young trainer in the area," Crandall remarks. "Tim has trained with me and with Bill Nankivel as well as with several pros. He's as good a young retriever trainer as there is anywhere around. I'm proud of him."

Crandall also runs the Yellowstone Kennels, located just south of Sidney on County Road 122. He enjoys the kennels, and says that eventually the kennels will become the major portion of his business endeavors. "As I slow down in training, boarding is expanding," he concludes. "I like having dogs around, and I like to watch them. I have my training dogs but I also run a kennels but I do ask people to make reservations for boarding in advance."

THE PINNACLE OF REAL WORLD TOUGH.

- Industry first: Electronic Power Steering system • 686cc liquid-cooled, four-stroke engine • Yamaha Fuel Injection (YFI) • Industry-exclusive, fully automatic Ultramatic® transmission • Three-position On-Command® In/Out 4WD • Fully independent long-travel four-wheel suspension



1645 S. Central
www.mondakmotorsports.com



ATVs with engine sizes over 90cc are recommended for use only by riders age 16 years and older. • Yamaha recommends that all ATV riders take an approved training course. For safety and training information, see your dealer or call the ATV Safety Institute at 1-800-887-2867. • ATVs can be hazardous to operate. For your safety, always avoid paved surfaces. Never ride on public roads. Always wear a helmet, eye protection and protective clothing. Never carry passengers. Never engage in stunts, riding and alcohol/drugs don't mix. Avoid excessive speed. And be particularly careful on difficult terrain. Specifications subject to change without notice. Shows with optional accessories. ©2011 Yamaha Motor Corp. U.S.A. All rights reserved. • yamaha-motor.com

GUNS 'N' THINGS, LLC

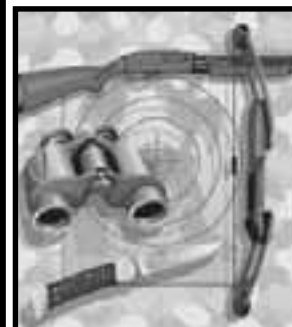

- SELLING**
- ✓ Fire Arms
 - ✓ Accessories
 - ✓ Re-Loading Equipment
 - ✓ Ammunition
 - ✓ Gun Safes
- PLUS:**
- ✓ Gun Smithing
 - ✓ Special Orders
 - ✓ Gift Certificates
 - ✓ Smartwool Socks
 - ✓ Montana Mapping
 - ✓ Landower Chip for your GPS

406-377-3969 or 939-GUNS
9am-6pm Mon-Fri; 9am-4pm Sat; Closed Sun
305 N. Merrill, Glendive, MT

Welcome Hunters!



Stop In For All Your RV Accessories!
Heated Hose Available!

Amunrud's RVs

Sales & Service Since 1969
(406) 433-2226 • 1-800-399-2226 • Hwy 16 S., Sidney, MT
www.amunrudsvinc.com



Give your opinion on any story at
Roundup
WEB.COM

Left: Tess makes a dash to retrieve an object thrown by Crandall.

Below: Tess successfully makes the retrieve.

Plan A Hunt For Up & Coming Hunters

It is easy for veteran hunters, dads and granddads to plan traditional hunts to favored spots. But sometimes, in the excitement, the needs of young hunters in the family may be overlooked.

Montana Fish, Wildlife & Parks officials encourage experienced hunters—family or friends of family—to take the time to mentor young hunters.

FWP helps make it easy by offering special seasons and other license opportunities. Here are a few of these special opportunities for young hunters.

Oct. 20-21 is a statewide, two-day, youth-only deer season. The season, authorized by the FWP Commission, provides young people an opportunity to participate in a deer hunt. Legally licensed hunters ages 11-15 may hunt deer statewide. For details see the deer, elk and antelope hunting regulations.

A youth 11 years of age who will reach age 12 by Jan. 16, 2012 may also, after Aug. 15, hunt any game species for which their license is valid during an open season. They may also purchase a hunting license, except for spring turkey and spring black bear, and apply for any drawing, as long as they have proof of completing an approved hunter education course.

In certain hunting districts young people ages 12-15 may hunt elk according to specific hunting district regulations without applying for an elk permit through the drawing. The specifics on these opportunities vary, so be certain to check the hunting district regulations.

Keep in mind that young people, resident and nonresident, ages 11-13, must be accompanied by a responsible adult 18 years of age or older in order to carry or use a firearm in public.

In other incentives, youngsters who complete a hunter safety and education course are entitled to receive their first resident youth combination sports license free-of-charge.



Welcome Hunters

Pizza Burgers & More!

Open: Tues. - Fri. at 4:30 p.m.
Sat. & Sun. at 2 p.m.
Fairview, MT • (406) 742-5180

Craig's MEAT PROCESSING 776-2447

Savage, Montana
NEW ADDITION
SLAUGHTERHOUSE

- custom meat processing • curing & smoking
- sausage & jerky • wild game
- slaughter at the plant or your farm

Hunting Licenses Ammunition Fall Clothing

809 East Main, Sidney, MT • 406-433-3400

Now Open Mondays!

SIDNEY Liquor STORE

809 E. Main, Sidney, MT
406-433-2862
Your only local retail sales outlet

4x4 Hunter Specials

Stk#	Year	Model	Price	Mileage
5761	2005	Ford F350 Crew Diesel	113,110	mi.
5769	2008	Ford F150 Crew XU Gas	81,815	mi.
5779	2008	Ford F250 Crew Diesel	61,331	mi.
5782	2007	Ford F150 Crew Lariat Gas	116,176	mi.
5784	2006	Ford F250 Sup/Cab Diesel	29,620	mi.
5791	2003	Ford F150 Crew Diesel	120,427	mi.
5795	2007	Ford F150 Crew Lariat Gas	103,141	mi.
8315	2001	Chevy 1500 Ext Cab Gas	113,046	mi.
8316	2004	Chevy 3500 Ext. Cab Gas	209,555	mi.
7122	2001	Dodge Dakota CC	106,500	mi.
8313	2007	Chevy Suburban	101,299	mi.

Experience the Eagle Country Difference!
215 East Main • Sidney, MT • 433-1810 or 1-800-482-1810

We Can Make Your Hunting Trip Safer!

Eton FR360 Solarlink Radio

- 7 channels of NOAA weather alerts
- AM/FM radio
- 3 built-in LED white lights and 1 red flashing LED
- Can be powered from 4 different sources

\$59⁹⁹

Cyber-shot® Digital Camera TX10

- Certified waterproof, dustproof, shockproof & freezeproof
- 16.2-megapixel "Exmore R" CMOS sensor
- 3.0" touch screen
- iSweep Panorama Mode
- Full HD 1080/60i
- Superior Auto

\$329⁹⁹

Rayovac Sportsman® Xtreme™ 3-Watt LED Flashlight

- Lightweight & water resistant
- 3-watt LED has 80 lumens that are up to 50 times brighter than a standard LED

\$29⁹⁹

Eton Scorpion Multipurpose Emergency Radio

- Crank powered AM/FM radio and LED flashlight
- Access to weather forecasts, alerts & other emergency messages with the NOAA weather band
- Charge virtually any phone with built-in USB charger

\$49⁹⁹

Motorola MS350 FRS/GMRS Two-Way Radio

- Waterproof up to 3 ft. for 30 minutes.
- Features up to a 35 mile range* with both FRS and GMRS
- Headset Connector
- Hourglass shape for reducing hand fatigue & comfort

\$99⁹⁹

Micro Headlamp

- Crystal reflector tube system
- 3 high quality LEDs, 1 white in front, 2 blue safety lights in rear
- Hinged attachment to position beam, adjustable straps for a snug fit

\$19⁹⁹

ELECTRICLAND

120 East Main St. • Village Square Mall
Sidney, MT 59270 • 406-433-4370
Hours: Mon.-Fri. 9 a.m. to 6 p.m.
Sat. 9 a.m. to 4 p.m.

No need to "Hunt" for great food!

- ★ Everything Homemade
- ★ Homemade Pie
- ★ Daily Soup & Sandwich & Dinner Specials
- ★ Breakfast 'til 10:45 a.m.

"Sadie's"

Open 5:00 a.m. - 3 p.m. Mon-Fri.
 Located in the Yellowstone Livestock Center
406-433-9949

Welcome Hunters

Valley Fuel

Hunting Licenses Available!

Fuel • Food • Snacks

5 a.m. to 8 p.m. - 7 days
406-776-2354
 Hwy 16 • Savage, MT

IN ADDITION TO CARS, TRUCKS & FARM IMPLEMENTS

WE HAVE TIRES FOR

- Horse Trailers
- ATV's
- Boat Trailers
- Flatbed Trailers
- Utility Trailers
- Campers
- Motor Homes
- Garden Tractors
- Golf Carts
- Wheelbarrows
- Tillers If we don't have it, we can get it! We can also get rims.
- More

Western Tire Co.

1601 SOUTH CENTRAL • SIDNEY, MONTANA
 433-3858 • Open 7-5:30 M-F & 7-Noon Sat.

THE DEPOT

Casino

POKER KENO

HAS PIZZAZZ

PIZZA & FINE FOODS

• WE DELIVER •

Hwy. 16 S, Sidney, MT • 406-433-4650

HUNTING FOR A PLACE TO STAY?

We've got a room just for you.

LONE TREE INN

900 S. Central, Sidney, MT
 406-433-4520

Pets Allowed

Continental Breakfast!

High Speed Internet

Richland MOTOR INN

Relax at the end of your day in our **Hot Tub!**

Check your email on our lobby computer!

1200 S. Central Ave, Sidney, MT • 406-433-6400



Cody Gibson shot this elk north of Winnetta Sept. 17. He had to hike six miles one way and watched the herd of about 80 head for 1½ hours. He watched this bull elk bugle and chase off 6-7 other bull elk. The bull then walked in front of him about 40 yards away in between a two-tree clearing where he aimed and released his first shot into the neck. He walked about 20 more yards where he shot two more times to make sure his elk was down. He scored his bull which is the measuring of inches on the antlers and his scored a 342.

2011 Deer Hunting Outlook

Montana's mule deer populations are generally at or below long-term averages across the state, especially in the eastern half of the state where the winter was particularly severe. White-tailed deer numbers are generally better, with good numbers in many locations except for areas in central Montana where deer experienced an outbreak of epizootic hemorrhagic disease late this summer.

FWP surveys show mule deer experienced major population decreases in northeastern Montana in FWP Region 6, especially in hunting districts 611, 630, 652, and 670. In those districts, antlerless mule deer "B" licenses were reduced by

more than 90 percent below last year's levels in some cases. In southeastern Montana around the Miles City area, mule deer populations are below the long-term average, though white-tailed deer populations are above the long-term average.

"If the weather cooperates this fall, deer hunters overall will likely experience average hunting conditions at best," Kujala said. "The dips in deer numbers experienced in some areas due to weather-related winter losses and reduced fawn production will take some time to climb out of."

For more on deer hunting, please check the 2011 deer, elk and antelope hunting regulations available on the FWP website at

fwp.mt.gov.

Here is a regional look at Montana's deer populations:

FWP Region 7—Southeastern Montana near Miles City

Mule deer populations are below the long-term average and white-tailed deer populations are above the long-term average.

Miles City and the surrounding area saw a severe, prolonged winter that reduced mule deer numbers and recruitment. Overall the mule deer population across the region is 12 percent below the long-term average. Recent recruitment levels, a measure of animals that survive the first year of life, averaged 41 fawns per 100 adults down from typical averages of 60 fawns per 100 adults.

Hunters Are Asked To Report Signs Of Wolves

State wildlife officials remind landowners, hikers, anglers, OHV riders and others in the outdoors this fall to report wolf sightings to Montana Fish, Wildlife & Parks.

The public's sightings help verify the activity, distribution and individual pack sizes of Montana's wolf population.

To report a wolf sighting, use the form found on the FWP website at fwp.mt.gov. Information about where, when and how many wolves are seen, and if possible the GPS coordinates of a sighting is especially helpful.

To learn more about Montana's wolf population, visit FWP online at fwp.mt.gov. Click Montana Wolves.

Permission Is Required To Hunt On Private Land

Hunters—don't delay. Montana law requires hunters to obtain permission for all hunting on private land.

Landowners may grant permission in a face-to-face contact or over the phone, in writing or by posting signs that explain the type of hunting allowed and under what conditions.

It is a hunter's responsibility to always carry a copy of the current hunting regulations and appropriate maps to ensure that he or she knows whose land they are on or what game may be legally taken.

See Us Before You Go!

- Ammo • Carhartt
- Camo & Hunter Orange
- Snacks, Pop
- 24 hr pumps

www.farmerelevatorchs.com

CENEX **CHS** **FARMERS ELEVATOR**

1281 S. Central, Sidney
 406-433-1401

Mon.-Sat., 6 a.m. - 9 p.m.
 Sunday, 9 a.m. - 6 p.m.

Major Credit Cards Welcome

LOOK BEFORE YOU SHOOT

One of the rules for any hunter is "be sure of your target and beyond." This is certainly true when power lines are in the area, or using an insulator as a target. The effects are far reaching if an insulator is broken. A lineman's life may be at risk, a person's life support equipment may fail and several families over a large area may be without power.

So look before you shoot.

Lower Yellowstone Rural Electric

Your Touchstone Energy Cooperative

3200 W. Holly, Sidney • 406-488-1602
www.lyrec.com

A Rebirth

By Christopher Eckhoff

I begin my annual rebirth in August. As the last of my client's training dogs goes home and the start of bird hunting season arrives, the process evolves. It always happens to me at some point while I'm doing my chores. I

relax my muscles from the continuous tension they have felt over the last five months of training bird dogs. But more importantly my mind starts to clear. I also begin to think about where I am this year as compared to last.

"OK", I say to myself, "here I am once again. Have I done the things this year I promised myself I would from last summer? Did I improve in my training abilities? Did I have any break-through dogs; lost souls who I helped find their way?" These and many other questions fill my mind, begging for answers I haven't had time to consider 'til now. The first stage of rebirth is reflection. You have to know where you have been before you can see where you are going. To my way of thinking a rebirth is a renewal of both the soul and the body.

So into August I go, catching up on painting the fence, or putting in the new lawn area around the kennels, things of this sort. As these chores unfold I begin to look around and really observe, not just look. Now the rebirth is in full swing but has not reached its apex until the first of September.

I experience two opening days as the bird hunting season begins. The first opener is with my wife. She will usually take a day off from work and we'll pack up a couple of our older dogs and go to a nearby field. Nothing fancy, just the two of us with our favorite dogs. Our hunt will last no more than a couple hours at most. The limiting factors this time of year are two; the heat of the day and our physical condi-

tion. Usually it becomes too hot to hunt by 10 a.m. and we are tired by then as well.

Enjoying the hunt is a vital part of the rebirth. To rejuvenate the soul, to move in harmony with nature, we have to let nature surround us with its parameters and accept them. If Joy and I were to set out to 'get a limit of birds' we would by necessity have to stretch these limits. This in turn puts an entirely different complexion on the hunt. Hunting then becomes a chore, a challenge, it takes on goals which one becomes compelled to achieve. It perverts the hunting experience.

Joy and I rarely talk during the hunt itself. The only conversation we may engage in has to do with seeing a covey of birds, or some tactical aspect involving teamwork on approaching a particular piece of cover. On this opener, Joy and I revisit our love for each other. Without words we come to remind ourselves of why we are still together after 35 years of marriage. This particular hunt isn't about shooting birds. Birds are merely a reason to walk the fields, to smell the grasses, to feel the sun. This first hunt for Joy and I is a communal rebirth, another small part of the overall process I experience each fall.

My second opener usually arrives three or four days into the bird season. I don't know exactly when it will come except it always happens during the first week.

During this week I know I will go hunting with one particular dog, just the two of us. It's important to me that the dog be the oldest one I have, it's part of the ritual.

When the day is right I grab the dog and head out. I know the hunt will be a short one. The two of us will venture forth with the bare essentials. I'll have to carry water, more for the dog than myself but appreciated by both. Other than that, I pocket only a few shotgun shells. I'll wear my lightest hunting vest, most likely a short sleeve shirt and a pair of old, trusted blue-jeans.

Once in the field, quiet is the order of the day. The advantage of taking the oldest dog is an instant recognition by that dog of what is to come. The exactness of the dog work is not a consideration at this time. It is of little consequence with older dogs. They are going to do what they are going to do and should be allowed a great deal of latitude in how they choose to go about their work. So, the whistle stays in the pocket and voice commands are kept to an absolute minimum.

The dog hits point, the bird is flushed and the gun discharged. The cycle is complete, the rebirth in place. This cycle of life flashes before my eyes. I capsule where I have been; where I am; and to a degree where I am headed. The picture is crystal clear, the understanding

unquestioned. Everything I have done throughout the year, all the experiences I have compiled over the last 12 months, every disappointment or elation I have had all come into focus in an instant and pass not before my eyes but rather before my soul.

The hunt is short as again the heat of day begins to make its play. As we head back to the truck the dog usually senses the end of the hunt even though we are a good 10-minute walk from the vehicle. Older dogs will come in at a quazi heel on their own accord. They know not only when the hunt is done, but more importantly when the experience is concluded. There is a difference.

The last element of this rebirth is to have the harvest of the day for the evening meal. This completes the appreciation of the life cycle and the rebirth. I'll not feel as I do at that moment for a year hence, and I know that each of these annual rebirths may be my last. One of these times there will be no rebirth, there will only be a closing hunt.

Christopher Eckhoff has been training bird dogs for over 30 years in Richland County. He has a book available titled "Following the Scent". This book can be purchased online, directly at Upland Kennel, Crane, or the Yellowstone Marketplace, Sidney.



This elk was shot on the Fort Peck Lake. It was a five-mile hike to get to the spot. It took him 3 shots to get the elk down.

This whitetail deer was shot near Glendive, MT fall of 2010. After sitting and watching this buck with does he finally gets a good shot, the deer went down and another bigger whitetail popped up not 40 yards away.



Spring coyote hunt in Glendive, MT, fall of 2011.



Welcome Hunters!

- Continental Breakfast
- Refrigerators
- Cable/HBO
- Wireless Internet
- Microwaves

Park Plaza Motel
601 S. Central A ve. Sidney, MT
406-433-1520 • Fax: 406-433-5245
For Reservations, Call 1-877-208-7092

Welcome Hunters!

Breakfast & Lunch Specials

Great Home Cooking!

5:00 a.m. - 4 p.m. • Monday - Saturday
5:00 a.m. - 2 p.m. • Sunday

T&C Diner
Marlene Emly 742-5060 Fairview, MT

Hunting
Think Trading Post

HUNTING FOR GEAR?

Excellent Selection Big Game Rifles, Shotguns & 22s.

Pawn Buy • Sell Consignments
TRADING POST

9 a.m. to 5 p.m. Mon. thru Sat.
1691 S. Central • Sidney 433-7676

We Have What You Need!

- Guns
- Ammo
- Optics
- Safes
- Hunting Supplies

JOHNSON
HARDWARE & FURNITURE
since 1915

406-488-1909 • 114 W. Main Street, Sidney, Mont. • www.johnsonhardwareandfurniture.com
Hours: Mon.-Fri. 8 a.m.-5:30 p.m. • Sat. 8 a.m.-5 p.m.

Sign Up TO WIN \$1,000 Shopping Spree

Don't Make Them Hunt For You!

Come Back Alive With Spot!
Emergency 911 service from anywhere. Tracking and texting available.

Take SPOT Along On Your Hunting Trip!

ADVANCED COMMUNICATIONS

"Your communication headquarters"

Just North of McDonald's • Sidney, MT
406-433-1659 • Toll Free • 1-866-433-1659

Harvest Days 2011

Attention Area Cooks...

Pull Out Your Tastiest Recipes & Enter Our

"Make It With Sugar" Contest

Friday, October 21 • Reynold's Grocery, Sidney

Entries accepted from 9 a.m.-10 a.m.

ENTER IN ANY OR ALL CATEGORIES!

Cake • Cookies • Pies • Candy • Breads • Rolls • Other



Prizes will be given away for first place in all categories

Plus a People's Choice Award!

All entries receive a FREE Bag of Sugar

**Over \$500⁰⁰
In prizes!**

"Make it With Sugar" Registration Blank

Name: _____

Address: _____

Phone: _____

Categories: (Check all that apply)

Cake Cookies Pies Candy Other Breads & Rolls

Mail to: P.O. Box 1207, Sidney, MT 59270

Sponsored by:

The Roundup

111 W. Main • Sidney, MT • 406-433-3306

- Recipes must contain at least 1/2 cup granulated, brown or powdered sugar.
- Must be servable in tasting portions.
- Recipe must be included. Winning recipes will be published.
- Entries must be in disposable containers. Containers will not be returned.



Watford City Sports Action

Left: Watford City's Amanda Mogen, #8, spikes the ball past a Stanley defender in Tuesday's match against the Blue Jays. Stanley defeated the Wolves 3-0. Below: Watford City's Josh Johnson, #22, gains a first down with help from his blockers Shawn Fulwider, #89, and Nate Egberg, #74 in Friday night's game against the Stanley Blue Jays. Stanley defeated the Wolves 41-7. (Photos by Kathy Taylor)



Sugar Beet Decorating Contest

In Conjunction with Harvest Days 2011



Age Groups

- 10-12 years
- 6-9 years
- 5 & Under



PRIZES
1st, 2nd & 3rd in each age group
First Prize \$20 Powder Keg Gift Certificate

Drop off your decorated beet at **The Powder Keg**

by Tuesday Evening, October 11

Prizes will be awarded & pictures taken at 3:30 p.m. on Wednesday, Oct. 12TH at the Powder Keg.

Sponsored by The Roundup and Fairview businesses.

PREBUILT HOMES
BUILT IN SMALL TOWN USA & MOVED TO YOUR TOWN ASAP!
For more information contact: Toby Romo at 406-769-2094
romocarpentry.com
HOMES BY BAINVILLE, MT

NEU CONSTRUCTION, INC.
Oil Field Roads & Locations
• Reclaim Work
• Gravel & Scoria Hauling
Fairview, MT
406-742-5549

LONG X BOTTLE SHOP
In-store specials every week. Check out our hard ice cream!
8 a.m.-9 p.m. Hwy. 85, Watford City
Mon.-Sat. 701-444-3335
1-5 p.m. Sun.
(Located in Long X Visitors Center)

TAYLOR Ag Service
Kent Taylor, Owner
Watford City, ND
701-444-3772
Licensed in ND & MT

RTC
Smarter. Better. Faster.
www.RTC.coop
VOICE • DATA • VIDEO

HURLEY'S OILFIELD SERVICES
• Potable Water • Sewer System
• Loaders • Communications
• Backhoe • Trucking
• Skid Houses • Porta Potties
406-742-5312
Fairview, MT

Sports Booster WEEKLY SCHEDULE

Volleyball

Thursday, Oct. 6
Bainville at Brockton, 6 p.m.
Fairview at Savage, 6 p.m.
Trenton at Watford City, 7 p.m.
Friday, Oct. 7
R&L vs Saco/Hinsdale at Saco, 4 p.m.
Froid/Lake at Nashua, 6:30 p.m.
Saturday, Oct. 8

Scobey Invitational: Old Gym:
Fairview JV vs Bainville, 9 a.m.; Saco/Hins vs Fairview, 9:45 a.m.; Terry vs Fairview JV, 10:30 a.m.; Saco/Hins vs Froid/Lake, 11:15 a.m.; Bainville vs R&L Fusion, noon; Saco/Hins vs Grenora/Westby, 12:45 p.m.; Nashua vs Savage, 1:30 p.m. West Gym: Terry vs Nashua, 9 a.m.; Scobey vs Grenora/Westby, 9:45 a.m.; Savage vs Bainville, 10:30 a.m.; Culbertson vs Scobey, 11:15 a.m.; Nashua vs Fairview JV, noon; Fairview vs Culbertson, 12:45 p.m.; Terry vs Bainville, 1:30 p.m.; East Gym: R&L Fusion vs Savage, 9 a.m.; Culbertson vs Froid/Lake, 9:45 a.m.; R&L Fusion vs Nashua, 10:30 a.m.; Grenora/Westby vs Fairview, 11:15 a.m.; Terry vs Savage, noon; Froid/Lake vs Scobey, 12:45 p.m.; R&L Fusion vs Fairview JV, 1:30 p.m.
Watford City at Beach Tourney: North Court: 9 a.m. - Beach vs Bowman, Flasher vs Watford City, Watford City vs Beach, Bowman Co. Vs Flasher, Watford City vs Bowman Co., Flasher vs Beach. South Court: 9 a.m. - Heart River vs Killdeer, Wibaux vs Richardton, Richardton

vs Heart River, Killdeer vs Wibaux, Richardton vs Killdeer, Heart River vs Wibaux.

Tuesday, Oct. 11
Plentywood at Sidney, 7 p.m.
Bainville vs Grenora/Westby at Richey, 4:30 p.m.
Poplar at Brockton 6 p.m.

JV Volleyball

Thursday, Oct. 6
Trenton at Watford City, 6 p.m.
Monday, Oct. 10
R&L at Jordan JV, 4:30 p.m.
Watford City at Dickinson, 7:30 p.m.
Tuesday, Oct. 11
Plentywood at Sidney, 5:30 p.m.

Varsity Football

Friday, Oct. 7
Hardin at Sidney, 7 p.m.
Scobey at Bainville, 7 p.m.
R&L vs Savage at Richey, 7 p.m.
Jordan at Savage, 7 p.m.
Froid/Lake at Fairview, 7 p.m.
Williams County at Watford City, 7 p.m.

JV Football

Monday, Oct. 10
Savage at Terry, 4 p.m.
Fairview vs Froid/Lake at Med. Lake, 4:30 p.m.
Watford City at Ray, 6:30 p.m.

Cross Country

Saturday, Oct. 8
Sidney, Bainville at Miles City, 11 a.m.

Support Your Favorite Team

M&M Cafe
All buses and fans call ahead for later hours!
1721 S. Central Ave. Sidney
406-433-1714

Be Sure To Thank The Sports Booster Schedule Sponsors On This Page

Casino & Lounge
Behind The Lone Tree Inn In Sidney
Happy Hours 4-6 Weekdays
50¢ Off All Drinks

Family Dining
POWDER KEG Fairview
406-742-5180
Open at 4:30 p.m. Tues.-Fri.
2 p.m. Sat. & Sun.

HOT STUFF PIZZERIA
FOOD ON THE GO
Farmers Union Oil Co.
101 S Main • Watford City
701-444-3639

We Support All The Area Teams!
Member FDIC
Main St. • Alexander • 701-828-3338
100 N Main • Watford City • 701-842-2381

The Roundup Classifieds

Reach Over 21,000 Readers Each Week
In Eastern Montana & Western North Dakota
And Always On The Internet at
roundupweb.com

*Add a photo
to your classy
online!*

\$7 up to 30 Words

Classy Deadline: Noon Monday

HELP WANTED

HELPWANTED
In store help wanted.
McKenzie Building Center,
Watford City. 701-444-3665.

**Robinson
Construction Group**

is currently looking for a
**Heavy Equipment
Diesel Mechanic**
for Watford City, ND.
Salary DOE
Email resume to:
shawnee@rrobinson.net

AD REPRESENTATIVE

Be a part of the most effective media outlet in the MonDak region. The Roundup is looking for an enthusiastic, go-getter that doesn't mind having an unlimited earning potential.

Your local Bible Book Store. If we don't have it, we'll order it for you.
**119 So. Central
Sidney, MT**
406-433-3355
www.carpentersstorehaus.com
www.gloriasdiscovery.com

Represent a successful regional newspaper in western North Dakota that has been a mainstay of the MonDak area for 30 years! Send resume and applications to The Roundup, PO Box 1207, Sidney, MT 59270 or apply at local Job Service.

ACTIVITIES AID

Roosevelt Medical Center is looking for someone to interact with residents. Serving morning & afternoon snacks, exercises & other activities.

For more information contact Vicki Grimsrud at 406-787-6401. EOE/ADA.

BUSINESS OPPORTUNITY

START YOUR OWN BUSINESS - RETAIL OR OFFICE
Retail & office space is now available in Yellowstone Marketplace, Sidney's new downtown mall. Modern mall units are located in historic building in the heart of downtown at Main St. & Central Ave. Call Russ Wells, 406-489-7431.

YOGA STUDIO

Everything you need, great location in downtown Sidney. Call Erin, 406-480-2874.

FOODTRUCK. GREAT \$\$\$ OPPORTUNITY

'85 Step side custom food truck, 350 Chevy motor, all stainless steel, fridge, freezer, double deep fryer, grill, cold & hot plate, oven, cash register, new microwave, new Honda 5000 generator, all new batteries, 4 sinks, \$25,000 OBO, 701-464-3389, leave message.

Randy's General Contracting
Specializing in:
• High Quality Windows
• Painting • All Roofing
• Vinyl or Steel Siding
• Small Additions • Yard Work • Curbs
• Patios, Awnings & Rain Gutters
Beat the High Cost of Big Businesses...
Small or Large Jobs Free Estimates 406-488-4768 Cell 406-478-9027 Sidney, MT

REAL ESTATE

CONDO FOR SALE BY OWNER
2 bdrm., 1 1/2 bath, new remodeled kitchen w/hickory cabinets, granite counter tops, stainless steel sink & appliances, log railing, tile floors, upgrades throughout, \$125,000. 406-480-4215 or 406-488-4219 for private showing.

GOLD TO BE FOUND
10 acres patent mining claim & all mining equipment. Need help operating, for sale or lease, \$400,000 or joint venture. 406-422-7812.

FOR SALE
4 bdrm., 3 bath home in Plentywood. Unattached 2-car garage, \$82,500. 406-765-2686 or 406-480-2497.

FOR SALE
Almost one acre, with six city lots in Rawson (between Watford City & Williston) on two maintained frontage roads with water, sewer, electric. Great location for RVs or Bakken Oilfield business. 701-770-0659 or 701-840-3214.

FOR RENT

FOR RENT
2 bdrm. furnished house on 1 acre in Savage, \$2,200/mo. 406-776-2209, leave message.

FOR RENT
Private lot in Richey, MT. Shaded trees, full hookups. 406-377-1908 or 307-856-1435.

SERVICES

HOT SHOT TRUCKING
Haul Lass, LLC is now servicing the area. Delivering anywhere, anytime! Reliable, responsible & local! Give me a call at 406-480-0126 or 406-488-6613, email hoffhd@hotmail.com or fax 406-488-6107. Dianna Hoff, Hauler.

AZURE MONUMENTS
Grave covers, markers, all colors & sizes, custom designs, scenes, final dates, pictures. We sell monuments, no extra charge for lettering. 406-766-2326. Box 2, Froid, MT 59226 or 863-494-0136, 406-790-0338.

WELDING
Welding & repair work. No job is too small. Portable welder, reasonable rates. 701-444-2936.

GENE'S MONUMENTS
Monuments & markers to fit everyone's needs. All colors & sizes. 406-482-1967 or cell, 406-480-2144. Gene Hueth, 709 8th St. SE, Sidney.

SIDNEY AIR SERVICE
Aircraft buying or selling. Call Barry, 406-488-4031.

COMPLETE SERVICE CENTER
The Roundup provides free fax service at Meuchel Computer Services, Watford City, for all news, photos & advertising copy. You may drop your Roundup payments at Meuchels.

Help Wanted

Sidney Sugars Incorporated is accepting applications for sugarbeet processing factory positions. The jobs begin in late September and are available until all beets and juice are processed, about mid-February.

- 🌻 **\$12.31/hour**
- 🌻 **Bid jobs \$13.67/hour and higher**
- 🌻 **Opportunity for advancement to full time positions**
- 🌻 **On the job training**
- 🌻 **Limited medical plan**
- 🌻 **Overtime may be available**
- 🌻 **Employee Referral Program**

**Apply in person or request an application from:
Sidney Sugars Incorporated
35140 County Road 125 - Sidney, MT - 406-433-9320
Apply at Job Service Work Force Center
211 N Central Ave - Sidney, MT
www.sidneysugars.com**



Sidney Sugars
INCORPORATED

Walk-ins are welcome!

Equal Opportunity Employer • Drug Free Workplace

The Roundup

Reaching over 8,400 Households in Western North Dakota and Eastern Montana Every Week
Classified Ad Order Form (Please Print)

1	2	3	4	5
6	7	8	9	10
11	12	13	14	15
16	17	18	19	20
21	22	23	24	25
26	27	28	29	30 \$7.00
31 \$7.10	32 \$7.20	33 \$7.30	34 \$7.40	35 \$7.50 (etc.)

\$7.00 for 30 words or less; additional words 10¢ each

Number of words _____ x Number of Times _____ = Cost \$ _____

Name _____ **Payment Must Accompany Ad**

Mail To:
The Roundup
P.O. Box 1207, Sidney, MT 59270

Companies:
NEED A PLACE TO CONDUCT YOUR BUSINESS?
Large building to be built and construction will meet your needs. Great location near Highway 16. Call 406-488-4338 for more info.

Mini-Storage
STORAGE UNITS AVAILABLE
20X20 • 10X20
10X16 • 8X9
Sidney, MT
482-3799 or 482-2666

S&S Motors
See the CLEARANCE tag specials!

- 2010 Ford F250 Lariat, 5k mi., crew/short **\$39,995**
- 2011 Chevy Traverse LTZ, blue, DVD, 9k mi. ... **\$38,995**
- 2011 Chevy Traverse LTZ, black, DVD, 24k mi. **\$38,995**
- 2011 Buick Enclave CXL, red, 28k mi. **\$37,995**
- 2010 Ford F150 King Ranch, maroon, Nav, 39k mi. **\$36,995**
- 2010 Ford F150 Lariat, red, 4x4, 23k mi. **\$34,995***
- 2009 Ford F150, maroon, 4x4, 41k mi. **\$34,995**
- 2009 Ford F250 XLT, long, crew, V10, 23k mi. ... **\$31,995**
- 2009 Ford F250 ZLT, crew, long, 41k mi. **\$29,995**
- 2008 Buick Enclave CXL, blue, DVD, 48k mi. ... **\$29,995**
- 2008 Dodge Ram 1500 Laramie, blue, 28k mi. **\$26,995**
- 2008 Buick Enclave CXL, 85k mi., tan, NAV ... **\$24,995**
- 2010 Ford Escape XLT, gray, 23k mi. **\$23,995**
- 2008 Nissan Pathfinder, blue, DVD, 45k mi. **\$19,995**
- 2007 Ford Expedition Eddie Bauer, 81k mi. **\$19,995**
- 2007 Subaru Tribeca, blue, 71k mi. **\$18,995**
- 2008 Dodge Caravan, black, DVD, 43k mi. **\$17,995**
- 2007 GMC Sierra 1500, silver, 151k mi. **\$17,995**
- 2008 Subaru Legacy, 52k mi., AWD **\$16,995**
- 2008 Ford Mustang, convertible, 29k mi., V6 ... **\$16,550***
- 2005 Chevy Colorado, 89k mi., crew, 4x4 **\$15,995**
- 2005 Dodge Grand Caravan, blue, DVD **\$8,995***

www.sandsmotorsinc.com
444-2341 or Toll Free - 800-584-9205 • Watford City, ND

SIDNEY AIR SERVICE
Get your aircraft appraised by the pro, certified aircraft appraiser member NAAA. Call Barry 406-488-4031.

AFFORDABLE CLEANING & GARDENING BY JANELLE
Commerical & residential, have references, flexible schedule, free estimates, reasonable rates, 15 yrs. exp. Top to bottom comprehensive service. Sidney area. 406-478-3689.

FARM & RANCH VERMEER HAYING EQUIPMENT
See us today for all your haying & feeding equipment, sweeps & Farm Oil. Anderson Vermeer Sales & Service. Open Mon.-Fri., 8 a.m.-5:30 p.m. 701-828-3358 or 701-828-3482 after hrs., Alexander.

FOR SALE
2010-11 alfalfa hay, 1200# bales, 2011 grass-alfalfa-clover bales. 406-489-3085.

*** * * * ***
GREEN ACRES SOD FARM
We grow grade A Kentucky bluegrass. Installation & Delivery are Available.
* Mon-Fri. 8 a.m. - 5 p.m. (mst)
* Sat 8 a.m. - 12 p.m. (mst)
* ***Orders for picking up Sat. morning need to be placed by 2 p.m. on Fri.
* Call ahead for orders.
* **701-744-5759** *
* * * * *

MISCELLANEOUS FOR SALE
FOR SALE
Brand new size 22 wedding dress. White w/red detailing. Matching veil & tiara. Girls' size 6 matching flower girl dress. Bought in '07 & both have never been worn & have never touched the ground. Purchased for over \$1,000, asking \$600 OBO for everything. Call Erin 406-480-3834.

EVERTHING GOES, ALL OFFERS WELCOMED
2 300 gal. galvanized water tanks, '63 Ford 1/2 ton 2 WD, steel pickup stock rack, steel shed, pitcher pump parts, cream cans, gate fasteners, scrap iron, lawn mowers, small old aluminum pickup camper, salvage fence wire, '50 Willys, '53 Willys, 1/2 ton hard coal, old shopsmith, very old camp trailer frame & axle. 406-489-1923.

FOR SALE
10 hp. air compressor w/120 gal. tank, 6.0 cu. in. motor (bad block), 3.8 cu. in. motor, 4.3 cu. in. motor. 406-433-2277 during the day with offers.

RECREATIONAL VEHICLES
FOR SALE
'03 Cedar Creek 5th wheel, Model 30RLBS. 2 slides, 750 watt solar panel, ducted a/c, heat, dinette table w/4 chairs, day/night shades, hide-a-bed sofa w/recliners, wired for satellite, etc., very well insulated, exc. cond. View photos on Craig's List-Helena area. 406-443-4357.

FOR SALE
'99 Teton RV, 40', 2 bdrm., 2 furnaces, ducted air, exc. cond. '11 Dodge 3500 Laramie diesel, all options, 11k mi.. 406-973-5712.

VEHICLES
FOR SALE
'10 Toyota Highlander LMT, heated leather seats, sunroof, 13k mi., beautiful car, we just need more room. Will sell under book. 406-488-4073 or 406-480-5371.

FOR SALE
'05 Freightliner C15, factory daycab, 10 spd. autoshift, factory pusher, full lockers, wet kit, 500k mi., new brakes, new tires. 701-770-6302.

WANTED
WANTED TO BUY
14' or 16' for 8830 swather header. 406-786-3307 or 406-786-7543.

LOOKING FOR A PARTS DELIVERY PERSON
Must have clean driving record. Experience preferred but not necessary. Call AJ 406.433.1810
Eagle Country
SIDNEY, MT
Experience the Eagle Country Difference!
215 East Main Sidney, MT 59270 406.433.1810

WANTED TO BUY
Fresh home grown vegetables for Betania. Contact Russ Wells, 406-489-7431.

GARAGE SALE
RUMMAGE SALE
Fri., Oct. 7, 1-6 p.m. & Sat., Oct 8, 8 a.m.-noon. 913 7th Ave SE., Sidney. Washer, gas dryer, Barbie house, furniture, misc. items.

Land For Sale
640 acres of pasture land. Smith Creek runs through the property & water rights to Smith Creek. There is a water well & electricity on the property. Very nice grazing property, approx. 17 mi. out on Hwy. 261. (Wibaux highway). Township 19, range 59 east Sec. 28. Call Steve at 406-482-3153 or 406-489-3366.

NEED EXTRA CASH?
OPENINGS AVAILABLE FOR THE BILLINGS GAZETTE SIDNEY & FAIRVIEW
Home Delivery Approx. 2 ½ hours in the morning
Approximately \$800 - \$1100 Every 4 weeks
No Collections!
Call Sherell Clark @ 657-1298 (x-5)
Or 406-740-1438

Property For Sale By Bids Richland County, Montana
Township 23 North, Range 51 East, MPM
Parcel #1 • Section 18: N½ • 320 acres +/-
Parcel #2 • Section 7: NW¼, S½, W½ W½ W½, NE¼ 485 acres +/- (May be subject to survey)
Bids Due October 14, 2011
For Additional Information Contact:
Roger Cymbaluk • Basin Brokers, INC
106 Main Street • PO Box 456 • Williston, ND 58802-0456
701-572-5560 or 1-800-572-5560

McKenzie County Sheriff's Department Job Fair
For 911 Dispatcher/Corrections Officer
The McKenzie County Sheriff's Department will be conducting a Job Fair for full-time & some part-time positions as 911 Dispatcher/Corrections Officer
Wednesday, Oct. 19, 2011
10 a.m.-3 p.m.
(just before school is out)
McKenzie County Courthouse Basement Meeting Room

✓ (Full-time) Blue Cross/Blue Shield Health Plan
100% Single, 80-20% split for single plus dependent & family
✓ Paid vacation & sick leave ✓ 2 full personal days/year
✓ longevity pay: \$175 for each year working for the County ✓ retirement package.

Salary: Full-time starting salary ranges from \$13-\$15.89/hour.
Experience Required: None — All training will be provided & paid for by the McKenzie County Sheriff's Department.
Requirements: Good communication skills, a basic understanding of computer programs, the ability to multi-task, like working with people, have the ability to deal with stressful situations & be willing to wear a Badge & Uniform.

DISPATCHERS TELL DEPUTIES & OFFICERS WHERE TO GO!
Dispatchers are the vital link between the community & its Emergency Responders, Fire, Fire & Rescue & Law Enforcement. You hear the sirens every day. You see an ambulance race past you on the highway, a fire truck dashes past your home with lights flashing, a Sheriff's vehicle is blocking the roadway. Who is responsible for sending them there? What you don't see is the "Behind Scenes" Emergency Dispatcher. This person is just as responsible in the giving of aid as the paramedic on board the ambulance. Learn how to answer the phone by confidently saying:
"911, WHERE IS YOUR EMERGENCY?"

ESTATE & MOVING Auction SALE TIME: 11:00AM
SATURDAY OCTOBER 15, 2011
LOCATION: UPPER MISSOURI VALLEY FAIRGROUNDS WILLISTON, NORTH DAKOTA

AUCTIONEER'S NOTE: Daniel has moved here to Williston from Minnesota, and has been paying storage on his items. Thus he has decided to sell the following at public auction. We have also added saddles & tack items from the Tom & Barb Johnson Estate. This is a very nice & clean variety of merchandise to be sold. There is not a lot of small boxed items. This is a must attend auction. Guns will sell at Approx 1:00PM. Thanks Chad.

VEHICLE • TOOLS • SHOP
1997 Chevy 1/2 Ton 4x4, Approx. 180,000 Miles • Pincor 3000 Watt Generator • B&S 8HP Horizontal Shaft Engine • (5) 48" Rigid Pipe Wrenches • Westward 2 Gal. Air Compressor (New) • Speed Air 4 Gal Air Compressor (New) • Makita 14.4 Volt Cordless Drill • DeWalt 12 Volt Cordless Drill • Black & Decker 18 Volt Cordless Drill • Craftsman 4HP 25 Gallon Air Compressor • Toro 8421 3 Speed 2 Stage Snow Blower • Stack On 6 Drawer Tool Box • 1 Ton Chain Hoist • Royobi 18 Volt Combo Set 4 Piece Set • Coleman 1750 Watt Generator • Chop Saw 14" • Shelving • Socket Sets • Submersible Pump • Belt Sander • 18 PC Combo Set • Heat Power Stripper • Sharpe Paint Sprayer • Powder Coating System • Electronic Caliper • Misc Air Tools • Log Chain • Vices • Car Ramps • 69 Piece Air Tool Set • Plumbing & Electrical Supplies • Vent Free Gas Space Heater • Chain Binders • Bench Grinder • Lawn Fertilizer • (2) DeWalt Angle Grinders • 6 Ton Press • 10" Garden Tiller • Wheel Barrow • Craftsman 2 Stage 21" Snow Blower • Milwaukee 2 Stage Turbine Airless Paint Sprayer • Chicago Electric Industrial Jack Hammer (Used Twice) • Simplicity 6 HP Snow Blower • JD 185 Lawn Tractor • Cub Cadet Lawn Tractor W/ Snow Blower Att. • (4) Michelin 235/70/16 Tires • (3) Cement Rakes • Shop Vac • Key Lock Box • LP Garage Hanging Heater • Heavy Duty Patches & Chisels • Other Misc Tools & Shop Items

GUNS & SPORTING GOODS
(2) Winchester 94 30-30 Lever Action Rifles • Remington Model 760 30-06 Pump Rifle W/ Marlin 4x33 Scope • (2) SS. Kregge 12 Gauge 2.34" Single Shot • Western Field 565-8A 2.34" Pump Shot Gun • Harrington & Richardson .22 Win Mag Model SS1 Ultra, Laminated Stock • Marlin 17 Cal. Bolt Action W/Clip Stainless/Laminated Stock • Remington Model 14 32 Rem Pump • Savage 63 .22 Cal Bolt Action Rifle • Savage 73 .22 Cal Bolt Action Rifle • Mossberg 25 .22 Bolt Action Rifle • Marlin 81ED .22 Tube Feed Rifle • Remington 572 Field Master .22 Cal Pump • Marlin 1894 12 Ga. Pump • Remington 10A 12 Ga. Pump • Shingisha Rifle Co. Model AR10 .22 Cal Bolt • H&R 852 Field Master .22 Cal Tube Feed • Western Field 12 Ga. Bolt W/Clip • Spring Field 87A .22Cal Semi-Auto W/Weaver Scope • Marwells 1922 12 Ga. Break Action • Steeger Uplander 16 Ga. Double Barrel • Fallon 137 Ranger 12 Ga. Double Barrel • Yamaha Kodiak 4x4 400 ATV 2700 Miles • Eastern Star Mini Bike • Jennings Buckmaster Compound Bow • Misc Tents & Poles • Ammo Boxes • (3) Homestead Portable Deer Stands • Meat Smoker (New) • Jiffy Ice Auger Model 30 8" • Jiffy Ice Auger Model 30 6" • Jiffy Legend Ice Auger Model 31 JHPK • (2) Stealth Wildlife Cameras • Ornel Matrix Safety Suit For Motor Cross • (3) Lawrence Sonar Computers • Hunter Elite Ambush Portable Deer Stand (New) • (3) Tackle Boxes Full of Tackle • (2) Binoculars (7x35 & 10x50) • Ambush Bobcat Elite XL Aluminum Deer Stand (New) • Gun Cleaning Kits • Misc. Bow Hunting Parts • Humming Bird Surface Temp Gauge For Boat • (8) Hard Gun Cases • Hoppers Clay Pigeon Thrower & Clips • 4th Portable Fish House • Shoei Helmet (XXL) • 2000 LB Mossy Oak Series Winch (New) • Aqua View Under Water Camera • Clam 5600 5th Portable Fish House • Gorilla Climber Deer Stand (New) • Gas Sport Grill • Coleman Table Top Gas Grill • 7.5 HP Honda 4 Stroke Outboard Motor • Vista Cam Under Water Camera • Hunting Blinds • Blaze Orange Hunting Coats & Bibs

ANTIQUES • COLLECTIBLES • FURNITURE
(3) 14 KT Gold Plated Elvis Presley Records • Approx 20 Wildlife Prints Framed & Matted (Nice) • Native American Dolls (24" Tall) • Solid Copper Fire Extinguisher • (6) Wurlitzer Micro Cassette Juke Boxes • Old Milk Can • Old Pump Jack • Eagle 25 Cent Gum Ball Machine • Portable TV • 2 Complete Sets of Charlie Schultz Peanut Characters Painted & Signed by Schultz 1 Set Framed • Old Telephone • Old Wooden Sleigh • Antler Lamps • Cast Iron • Misc Board Games • 3 Sets of Silverware Sets (New) • Couch • Love Seat • Recliner • Rocking Chair • (3) TV'S • Celebrity Pride XL Mobility Cart Battery Operated • 100+ VHS Movies • Mosquito Magnet • Metal Cooler

SADDLES & TACK EQUIPMENT
(3) Adult Saddles • (1) Child's Saddle • (3) Sets Of Spurs • Several Bits • Several Bridles, Halters, Lead Ropes • Horse Blankets • Stimps • Cinches • Other Misc Horse Tack

OWNERS: DANIEL WOJCIECHOWSKI MOVING OWNERS: TOM & BARB JOHNSON ESTATE
For Pictures & Auction Listings Visit Website At www.midwestauctions.com/smith
FOR FURTHER INFORMATION, CALL 701-774-7645 or 701-770-7645

SMITH AUCTION CO. **CHAD SMITH - AUCTIONEER LIC #750**
LYJEAN SMITH - CLERK LIC #388
LUNCH SERVED
The most important Auction is YOUR Auction. www.midwestauctions.com/smith

Mass Influenza (Flu) Shot Clinic To Be Held In Sidney

Richland County Health Department (RCHD) will hold a mass flu shot clinic at the Community Services Building on Wednesday, Oct. 12, from 10 a.m.-6:30 p.m. Medicaid, Medicare & CHIPS can be billed for those who bring their cards.

Everyone is encouraged to reduce their risk by getting a yearly flu vaccination which is the best way to prevent influenza and its severe complications. The Richland County Health Department will have plenty of vaccine available for

ages six months old through adult (99+years) at the mass clinic. No appointment is needed during the clinic.

Influenza vaccinations will be available throughout the fall and winter months since influenza activity can circulate anytime from November through April. RCHD would like to encourage all employers to send their employees to be vaccinated. Having illness from the flu can lead to lost work time for businesses. Groups may be billed—make arrangements

ahead of time by calling the health department.

The flu is caused by influenza viruses; the flu is a contagious respiratory illness with sudden onset of cough, chest discomfort, fever, chills and body aches; - **not the "stomach flu"**, which is characterized by vomiting and diarrhea. Influenza can cause mild to severe illness, and at times can lead to death. Influenza can lead to pneumonia and other complications depending on your current health and medical status. Along with getting a flu vaccination, please practice good hand washing, covering your cough, and staying home when feeling ill.

Flu vaccination shot will not give you the flu, because the vaccine does not contain live virus; it is "inactivated", containing only killed virus. It may cause soreness at the site of the shot area or a slight fever but these symptoms will not last long. Before anyone receives a flu shot, they will be screened about their health status to determine whether there is any medical reason that would make vaccination not recommended. The forms can be found on the Richland County web site (richland.org/health) and may be filled out in advance for the clinic.

RCHD is planning to move patrons through quickly and efficiently. Last year they vaccinated almost 800, with a time from entrance to shot average of 12 minutes per person. This year's clinic will be staffed again by many volunteers and staff. Believe it or not the best time to come is over your lunch time! There will be plenty of parking available. Get your flu shot!

For further information call the Richland County Public Health Department at 433-2207 or go to the website richland.org/health.



5th & 6th Grade Football

Tristan Kohntopp watches as Jace Johnson prepares to make a pass. Sidney's White Team defeated Williston's Purple Team 12-0 on Sept. 24 in Sidney. (Photo by Heather Johnson)

Sidney Health Center Named A "Top 100 Critical Access Hospital"

The National Rural Health Association (NRHA) recently announced the names of the Top 100 Critical Access (CAHs) in America and among the list was Sidney Health Center.

"I received an email from the Montana Hospital Association congratulating us on the Top 100 designation," commented Rick Haraldson, Sidney Health Center CEO. "I was thrilled to get the news and share the information with our staff. It is quite an honor when their commitment to providing exceptional care at all levels in the organization is recognized nationally!"

The NRHA named the Top 100 Critical Access Hospitals in the nation, as determined by the Hospital Strength Index, recognizing the top performance of hospitals that are the safety net to communities across the country.

Two other Montana hospitals made the list including Barrett Memorial Hospital, Dillon, and Community Hospital, Anaconda. The first-ever comprehensive rating of Critical Access Hospitals was analyzed by the Hospital Strength Index.

The Hospital Strength Index™ incorporates 56 different measures of performance to help identify those hospitals that are best prepared for success under the new healthcare reform. The Index includes a unique set of measures rating Market Strength, Value-based Strength and Financial Strength as key pillars for benchmarking and setting new goals under health reform.

The Market Strength includes competitive strength, intensity, size and growth factors essential to ACO development.

The Value-based Strength includes quality outcomes, patient perspectives, and cost and charge indicators that are essential for earning rewards under CMS' Value-based Purchasing reimbursement incentives.

The Financial Strength includes income statement and balance sheet ratios most predictive of long-term sustainability that are essential under an environment of reduced payments.

More detailed information about the Index can be found at www.HospitalStrengthIndex.com.

Savage Volleyball



Savage Senior Bridger Rice tips the ball over the net against Brockton. Savage won the match 3 to 0.

ROUNDUP TRADER



2008 GMC Yukon Denali
Excellent condition,
48,500 miles, loaded, \$36,000.
Located in Sidney
Call 406-489-0251



NEW 2008 32' Homestead
Arctic Pack, slide, loaded
Call 433-2226
See Amunrud's RV at
2695 S. Central or
www.amunrudsvinc.com



SIDNEY HEALTH CENTER

Exceptional Care for Life

Sidney Health Center is accepting applications for the following positions:

- Retail Food Services Cook
- C.N.A. - Nursery/MedSurg
- Medical Transcriptionist
- Clinic Patient Accounts Rep.
- C.N.A. - ECF
- Housekeeping

For additional information or to apply online, please visit our website at: www.sidneyhealth.org

- or contact -

Marilyn Olson
216 14th Ave SW • Sidney, MT 59270
Phone: (406) 488-2571
mjolson@sidneyhealth.org

Don't waste your recruitment \$\$\$

Reach 22,000 Readers In the MonDak Region Every Week



111 West Main • Sidney, MT
406-433-3306
www.roundupweb.com



2007 Ford F150	
Super Crew Lariat.....	\$25,900
2004 Chevy 2500, crew cab	\$15,900
2008 Chevy Impala LTZ	\$15,995
2004 Chevy 1500 ext. cab, 4x4	\$15,295
2002 Jeep Wrangler X	\$11,495
2003 Ford Crown Victoria	\$7,995
1984 Alegro Motor Home	\$5,000
2001 Buick Century	\$3,995
1997 Ford Taurus	\$3,295
1985 Ford 1/2 ton	\$1,895

701-586-3552 • Hwy. 85W • Arnegard, ND,

Lunch Menus

Richey Schools

Wed., Oct. 5: Super Salad Bar
Thurs., Oct. 6: Burritos, jojo's, pine-apple.
Fri., Oct. 7: Pizza & Salad bar
Mon., Oct. 10: Sloppy Joe, chips, pears.
Tues., Oct. 11: Fish nuggets, mac & cheese, applesauce.

Sidney Public School

Wed., Oct. 5: Tater Tot hot dish, peas & carrots, hot rolls, fruit.
Thurs., Oct. 6: Hot dogs, French fries, coleslaw, fruit.
Fri., Oct. 7: Hamburger gravy/ mashed potatoes, green beans, strawberry cups, pull aparts.
Mon., Oct. 10: Beef & bean burrito, salsa, calico corn.
Tues., Oct. 11: Pork rib sandwich, hash browns, fruit, cookie.

Rau School

Wed., Oct. 5: Hamburger gravy/ mashed potatoes, green beans, peaches, bread.
Thurs., Oct. 6: Chicken strips, Au gratin potatoes, carrots, mandarin oranges.
Fri., Oct. 7: Pizza roll ups, salad, chips, pears, ice cream.
Mon., Oct. 10: Chicken sandwich, scalloped potatoes, carrots, mixed fruit.
Tues., Oct. 11: Beef hoagies, smiley fries, salad, fruit.

E. Fairview School

Wed., Oct. 5: Hot dog, baked beans, carrot sticks, banana, cookie.
Thurs., Oct. 6: Meatloaf, mashed potatoes, broccoli salad, oranges.
Fri., Oct. 7: Hamburger, roasted potatoes, lettuce salad, apples.
Mon., Oct. 10: Chicken patty, garden blend rice, peas, apple sauce.
Tues., Oct. 11: Taco pasta bake, lettuce salad, peaches, pickles, bun.

Fairview School

Wed., Oct. 5: Macaroni & cheese hamburger hot dish, carrots, fruit, pudding, bread.
Thurs., Oct. 6: Beef pot pie, green beans, fruit salad, jello.
Fri., Oct. 7: Chili, cheese sticks, raw veggies, fruit, cumbread.
Mon., Oct. 10: Chicken noodle casserole, peas, fruit, bread.
Tues., Oct. 11: Super salad bar, potato, fruit, breadstick, pudding.

Lambert School

Wed., Oct. 5: Chicken nuggets, fries, carrots, celery, fruit.
Thurs., Oct. 6: Hobo stew, cheese crackers, cinnabuns.
Fri., Oct. 7: Spaghetti, corn, garlic bread, peaches.
Mon., Oct. 10: Corn dogs, gems, Jell-o, fruit.
Tues., Oct. 11: Chicken enchilada, veggies, fruit.

Culbertson School

Wed., Oct. 5: Hot dogs, chips, corn, peaches.
Thurs., Oct. 6: Meatballs/gravy, mashed potatoes, fruit, jello.
Fri., Oct. 7: Chicken nuggets, smiles, applesauce, cupcakes.
Mon., Oct. 10: Corn dogs, hash brown, s mandarin oranges, green beans.
Tues., Oct. 11: Taco in a bag, lettuce, applesauce.

Savage School

Wed., Oct. 5: Barber poles, chicken noodle soup, apricots.
Thurs., Oct. 6: Taco soup, pine-apple, bread, cookie.
Fri., Oct. 7: Burrito, tossed salad, mandarin oranges.
Mon., Oct. 10: Chicken patty/bun, gems, pears, jello.
Tues., Oct. 11: Spaghetti wiener casserole, peas, mandarin oranges, bread, pb&j.

Froid School

Wed., Oct. 5: Meatloaf, baked potatoes, peas, cherry delite salad, buns.
Thurs., Oct. 6: Tater tot hot dish, relish tray, applesauce, molasses cookies, buns.
Fri., Oct. 7: Tomato soup, grilled cheese sandwich, relishes, pears.
Mon., Oct. 10: Chicken strips, salad bar, banana bread.
Tues., Oct. 11: Stomboli, potato bucks, fruit jello, relishes.

Bainville School

Wed., Oct. 5: Chalupas & fruit.
Thurs., Oct. 6: Baked ziti, broccoli, garlic toast, strawberries.
Fri., Oct. 7: Grilled cheese sandwiches, tomato soup.
Mon., Oct. 10: Hot pockets & fruit
Tues., Oct. 11: DBL Stuffed Pizza & pineapple.

CERTIFIED PRE-OWNED
CHEVROLET BUICK GMC
No Worries.™

Introducing Owner Care: a pre-owned vehicle benefits package that raises our already-great coverage exclusive 2-year/30,000 Mile¹ Standard CPO Maintenance plan, which includes oil changes, tire rotation, (MPVI)². We also give you the added security of a 12-Month/12,000-Mile³ Bumper-to-Bumper Warranty Limited Warranty. Plus you get 24/7 roadside assistance with courtesy transportation during the Power Day/150-Mile Customer Satisfaction Guarantee. Owner Care is No Worries™ on a whole new level.

¹Whichever comes first. See participating dealer for details. ²Multi-Point Vehicle Inspection. A comprehensive vehicle inspection performed by a qualified technician, that includes multiple points of inspection, and more. ³Whichever comes first, time or date of purchase. See participating dealer for limited warranty details. ⁴Whichever comes first, time or date of purchase. See participating dealer for limited warranty details.

 2010 Chevy Cobalt #U3835A 31,000 Miles \$15,995 \$239.43* per mo./60 mo.	 2009 Chevy Impala #K30301 23,000 Miles \$19,995 \$299.31* per mo./60 mo.
 2010 Chevy Malibu #U3837A 32,000 Miles \$18,995 \$284.38* per mo./60 mo.	 2008 Chevy 1500 Crew Cab LTZ #C3853A 20,000 Miles \$32,995 \$493.90* per mo./60 mo.
 2010 Chevy Equinox AWD #U4002A 38,000 Miles \$26,995 \$404.09* per mo./60 mo.	 2009 GMC 1500 Crew Cab SLT #C3526A 34,000 Miles \$34,995 \$523.84* per mo./60 mo.
 2009 Chevy Traverse AWD #U4003A 35,000 Miles \$26,995 \$404.09* per mo./60 mo.	 2010 Chevy Impala #U4004A 34,000 Miles \$18,995 \$284.34* per mo./60 mo.

MORE QUALITY USED VEHICLES AT MURPHY MOTORS

 2009 Chrysler 300C #C3608B 31,000 Miles \$33,995 \$508.87* PER MO./60 MOS.	 2010 GMC 2500 Crew Cab LTZ #C3563A 49,000 Miles \$36,995 \$553.78* PER MO./60 MOS.			
 2010 Chevy 2500 Ext. Cab LTZ #U3585A 14,000 Miles \$37,995 \$568.75* PER MO./60 MOS.	 2010 Chevy Camaro 2LT V6 #C3479A 6,300 Miles \$27,995 \$419.06* PER MO./60 MOS.			
 2008 Honda Ridgeline #U3623B 34,000 Miles \$26,995 \$404.09* PER MO./60 MOS.	 2009 Honda Fit #G3395A 36,000 Miles \$17,995 \$269.37* PER MO./60 MOS.			
 2008 Ford Focus #U2952C 31,000 Miles \$12,995 \$194.52* PER MO./60 MOS.	 2008 Hyundai Santa Fe AWD #C312MA 68,000 Miles \$19,995 \$299.31* PER MO./60 MOS.			
 2010 Ford F250 Crew Cab Powerstroke Diesel #G3374A 15,000 Miles \$46,995 \$703.47* PER MO./60 MOS.	 2012 Chevy Camaro SS Convertible #C3912A 800 Miles \$39,995 \$598.69* PER MO./60 MOS.			
 2008 Ford Edge AWD #C3414B 48,000 Miles \$22,995 \$344.21* PER MO./60 MOS.	 2009 Honda Accord Coupe #U2826B 6,000 Miles \$24,995 \$374.15* PER MO./60 MOS.			
 2008 Chevy Suburban #C3443A 73,000 Miles \$28,995 \$530.52* PER MO./60 MOS.	 2008 Chevy Avalanche #C366AA 82,000 Miles \$26,995 \$493.92* PER MO./60 MOS.			
 2009 Ford F150 Super Crew #C3867A 48,000 miles \$32,995 \$493.90* per mo./60 mo.	 2007 Lexus ES 350 #B3212A 72,000 Miles \$22,995 \$420.74* per mo./48 mo.	 2008 Chevy Corvette Convertible #C3453A 7,000 miles \$43,995 \$658.56* per mo./60 mo.	 2008 Mazda 3 #U3108B 23,000 miles \$16,995 \$254.40* per mo./60 mo.	 2005 Pontiac G6 V6 #G3791A 43,000 miles \$13,995 \$256.06* per mo./48 mo.

* Payments based on 4.65% APR, O.A.C., 20% down payment or trade allowance, tax, title, license & doc fee extra.

MURPHY MOTORS

1801 2nd Ave. W. Williston, ND
 Call 1-800-888-2927 or 701-577-2927
 Hours: Mon. 8am-8pm, Tues.-Fri. 8am-6pm, Sat. 9am-5pm

SEE THESE SALES CONSULTANTS FOR QUALITY CAR BUYS!

24 YEARS 1987-2011

www.murphyautomotors.com

Anna Luft's 90th Birthday Party!
 The children of Anna Luft invite you to share in the celebration of Anna's 90th Birthday!
Saturday, October 8th • 2-4 p.m.
 Culbertson Senior Citizen's Center
 208 Broadway St.
 Lunch will be served.

Come To The Movies!
Tues. - Thurs., Oct. 4 - 6
Crazy Stupid Love @ 7:30 p.m.
Fri. - Thurs., Oct. 7 - 13
The Help @ 7:30 p.m.
& Sat. Matinee @ 1 p.m.
 Adults: \$6
 Students: \$5
 Matinee \$4
Centre Theatre
 Call Our Hotline for updates - 406-480-6684 (MOVIE) • Sidney

Sidney Cross Country Results

The Sidney Cross Country team competed in a meet in Colstrip Thursday, Sept. 22.

Freshman, Lakayla Nentwig led all the Sidney runners, finishing 14th out of 59 Varsity runners with a time of 24 minutes and 02 seconds. Senior, Lizzy Gangstad finished second highest in 35th with a time of 26 minutes and 53 seconds.

Full results:

Place, Name, Time
 High School (59 Varsity runners)

- 14, Lakayla Nentwig, 24:02
- 35, Lizzy Gangstad, 26:53
- 36, Katie Staffanson, 26:54
- 40, Tori Hill, 27:01
- 44, Lyndsay Nesper, 28:50
- 57, Sam Gangstad, 31:31
 (23 JV runners)
- 13, Lexi Hernandez, 29:16
- 19, Olivia Hintz, 37:05
- 20, Tresha Sanders, 37:17

- 21, Draven Partridge, 38:38
- 22, Stephanie Gomez, 40:16
- 23, Molly Wilkinson, 40:31
 Middle School runners
- 54, Mikayla Verhasselt, 16:21

The Sidney Cross Country team competed in a meet in Williston last Thursday

Freshman, Lakayla Nentwig, led all the Sidney runners, finishing 82nd out of 112 Varsity runners with a time of 19:00 minutes. Senior, Lizzy Gangstad finished second highest in 87th with a time of 19 minutes and 30 seconds.

Full results:

Place, Name, Time
 High School (112 Varsity runners)

- 82, Lakayla Nentwig, 19:00
- 87, Lizzy Gangstad, 19:30
- 95, Tori Hill, 19:58
- 102, Katie Staffanson, 20:57
- 105, Lyndsay Nesper, 21:22
- 110, Sam Gangstad, 21:46
 (35 JV runners)
- 28, Lexi Hernandez, 23:13
- 32, Draven Partridge, 25:39
- 34, Tresha Sanders, 27:30
- 35, Molly Wilkinson, 31:21
 Middle School runners
- (52 runners)
- 20, Tess Ler, 12:47
- 34, Mikayla Verhasselt, 15:18

The Sidney Cross Country team competed in a meet in Billings on Saturday.

Freshman, Lakayla Nentwig, led all the Sidney runners, finishing 72nd out of 130 Varsity runners with a time of 22 minutes 44 seconds. Senior, Lizzy Gangstad finished second highest in 85 with a time of 23 minutes and 26 seconds.

Full results:

Place, Name, Time
 High school (130 Varsity runners)

- 72, Lakayla Nentwig, 22:44
- 85, Lizzy Gangstad, 23:26
- 102, Tori Hill, 24:21
- 109, Katie Staffanson, 24:38
- 119, Lyndsay Nesper, 26:27
- 121, Sam Gangstad, 27:14
 (117 JV runners)
- 91, Lexi Hernandez, 27:34
- 107, Draven Partridge, 31:18
- 110, Olivia Hintz, 31:30
- 111, Tresha Sanders, 31:31
- 113, Stephanie Gomez, 34:06
- 116, Molly Wilkinson, 38:02

Savage Homecoming



Savage students Raigan Smith (left) and Teah Conradsen show their school spirit during the homecoming parade Saturday morning. Go to www.roundupweb.com for more Savage Homecoming pictures.

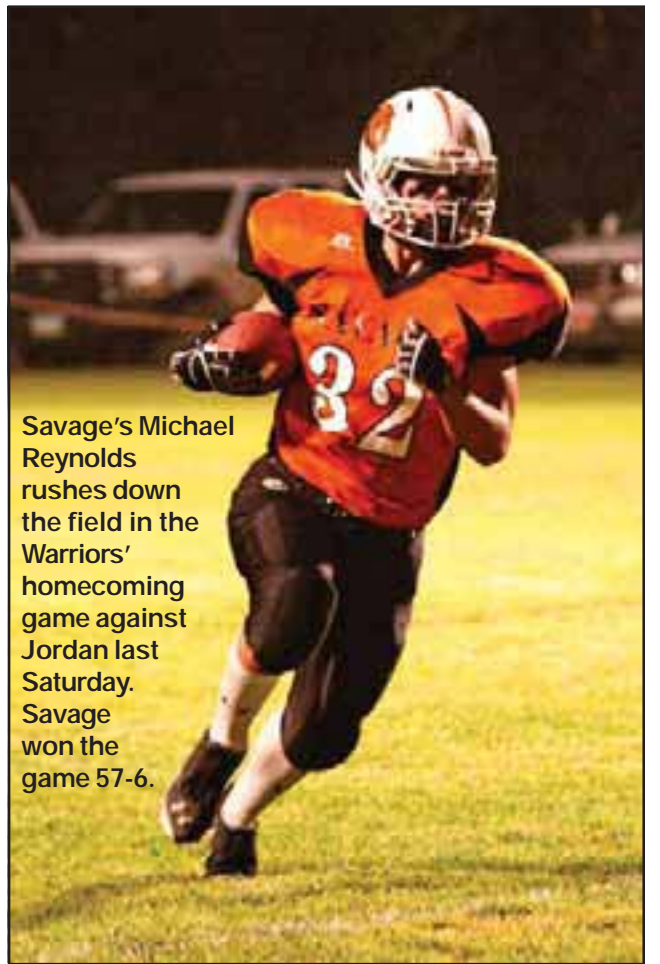

Savage's Michael Reynolds rushes down the field in the Warriors' homecoming game against Jordan last Saturday. Savage won the game 57-6.

Be The First To View This New Arrival! **\$98,895**

4 Bedroom/2 Bathroom • Formal Living Room • Family Room
 Kitchen Center Island with Sink • Skylight • Drywall Throughout • Approx. 1800 sq.ft.

Iseman Homes 2308 W. Front St. • Williston, ND 58801
 Since 1920 **701-572-2590**

We're More Than A Drug Store!

Now Carrying Montana West

Classic Fashion Rhinestone Boots & Flip Flops

- Brown
- Black
- Gray

Melissa & Doug

Buy 2 Get 1 FREE!

- *Trunki
- *Bubble Fun
- *Outdoor Lifestyles
- *Mealtime Fun
- *Sand Play
- *Art Supplies
- *Arts & Crafts Kits
- *Puzzles
- *Classic Toys
- *Dolls & Dollhouses
- *Large Plush Animals
- *First Play Soft Toys
- *Train Sets
- *Blocks
- *Learning Mats
- *Musical Instruments
- *Beginning Skills Activities
- *Puppets
- *Trucks & Vehicle Sets

New In The Store!

Marcia Baldwin Horse Canvases & Clocks

- Cowboy Up Clothing
- Painted Ponies
- Woodwick Candles

- Bean Pod Candles
- Feather Earrings & Extensions
- Fabric

Barrett Pharmacy & Variety
 9 a.m.-6 p.m. Mon-Fri • 9 a.m.-5 p.m. Sat
 701-842-3311 • 145 Main • Watford City, ND

Fall Open House
Celebrating 3 years!!!!

Wednesday, Oct 5th
10 a.m. - 7 p.m.

Lots of in Store Specials

Register for a \$300 gift certificate

Lucky Buckle
 122 South Central, Sidney, MT
 Mon.- Sat. 10 a.m.-5 p.m.